

[www.marmaramalzeme.com](http://www.marmaramalzeme.com)

**MARMARA®**  
MALZEMECİLİK

ürün katalođu  
product catalog  
2012-2013





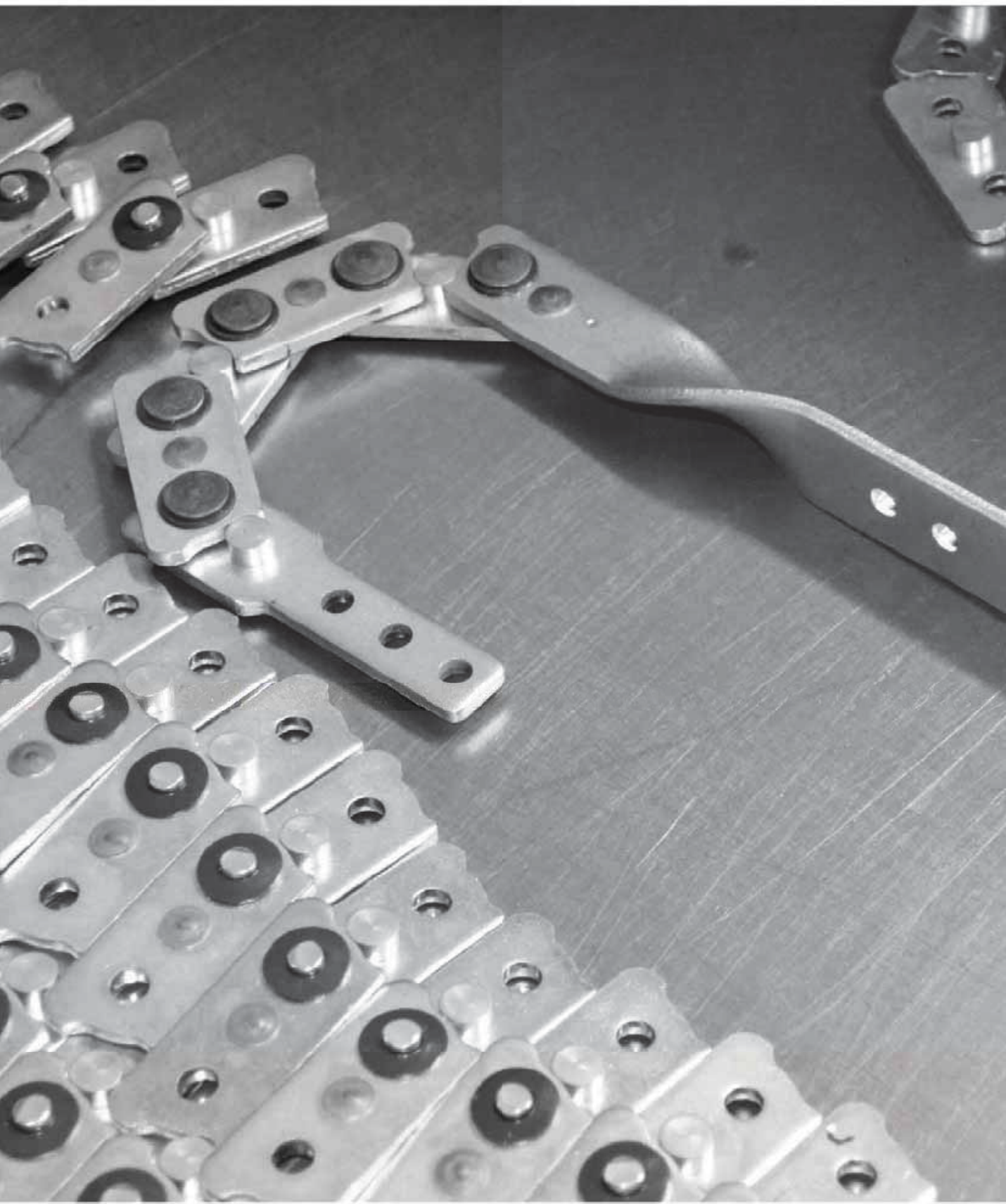

®

**EKSAN**

M E K A N İ Z M A



EKSAN kimdir sorusunu kısaca şöyle yanıtlamak mümkün: 100'ün üzerinde mekanizma çeşidiyle Türkiye'nin ve Avrupa'nın önde gelen kanepeler ve döşemecilik markalarına değer katan, üretimiyle ve hizmetiyle kazandığı müşteri memnuniyeti sayesinde sektörünün lideri olmuş bir firma...

40 yıla yaklaşan bilgi birikimimiz ve deneyimimiz ile EKSAN'ı kurduğumuz günden bu yana sektörümüzün bir adım önünde, yenilikçi ve müşteri odaklı bakış açısıyla üretmeye ve hizmet vermeye devam ediyoruz. Üretimimizin her aşaması işin uzmanları tarafından denetleniyor. Çünkü EKSAN'da üretim hattı boyunca en küçük bir ihmale bile tahammül göstermiyoruz. Ürünlerimizin kalitesinin istikrarlı olmasını ve müşteri memnuniyetini de bu yolla sağlıyoruz.

"Üretim boyunca kalite güvencesi" anlayışı, en üst kademesinden en alt kademesine kadar firmamızın tüm çalışanları tarafından benimsenmiştir. En iyiyi üretmemizin, zamanında ve uygun fiyatlarla teslim edebilmemizin ardındaki sır budur.

Sektörümüzün lider markası olmanın verdiği sorumlulukla sahip olduğumuz bu standartları da aşmak için AR-GE departmanımıza sürekli yatırımlar yapmaktayız..

Bizim için ürünlerimizin dönüştüğü diğer ürünler ve onların hem ulusal hem de uluslararası pazarlarda elde ettiği başarılar en büyük gurur kaynağıdır. Müşterilerimizi iş hayatımızdaki partnerlerimiz olarak görürüz ve bu yüzden onlara en kaliteli malzemeleri en iyi fiyatlarla sunarız. Başarılarındaki katkımızı görünce de en büyük ödülü almış oluruz.

Biz, üretimin, ürünün, çalışanın, üretenin ve emek verenin değerini bildiğimiz, ilkeli, dürüst ve kaliteden ödün vermeyen bir firma olduğumuz için başarılıyız. Çalışmalarımızı takdir eden ve üretimi için bize güvenen herkese sonsuz teşekkür ederiz.



## EKSAN MECHANISM

We can give an answer to the question of who is EKSAN: EKSAN is the leader of it's own sector by over 100 type of mechanisms which are preferred by the greatest companys of Turkey and Europe and so because of that became the leader of it's own sector.

We've been working with our all experiences and know how as an innovative and customer oriented company almost for 40 years. Every process of our production are expecting by experts. We can't be tolerant for any negligence in our works. We believe by only that way we can assure our customers to be happy.

We have a principe named "quality is quaranteed on every process of production". And our every employer has this principe. This is the secret of our best quality production and presenting right on time with best price.

With the responsibilty of being the leader of our sector we invest continiusly to go beyond our stardarts, we invest in our research and development department.

We are so proud of our product's success can do in national and also international sectors. We supposed our customers as our partners and that's why we offer them best products, materials with best prices. When we see our contribution in their success, we have our best award.

We are successfull, because we appreciate products, producing, workers and we are principled and never budge from the quality. Thank for all people who trust and appreciate us

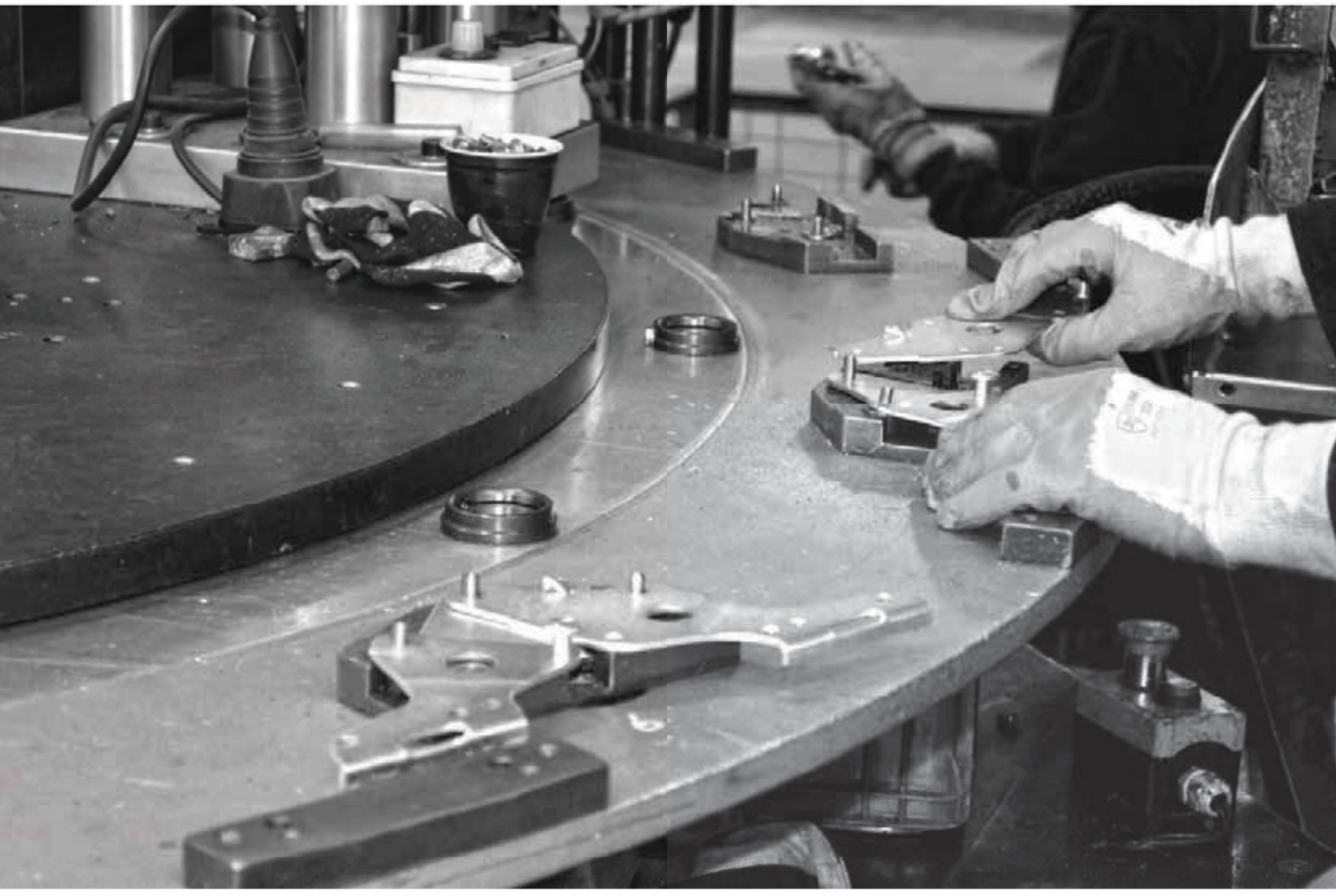





M02010228 Ürün No/Prod. No: 5  
BAŞLIK MEKANİZMASI  
HEADPIECE MECHANISM

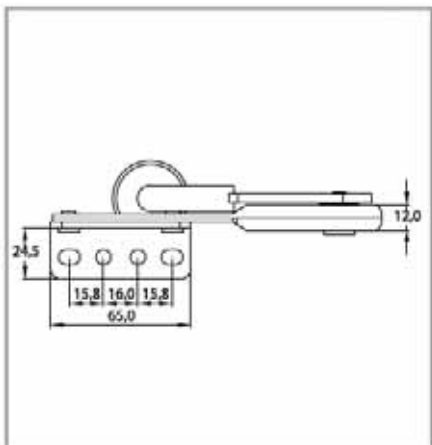
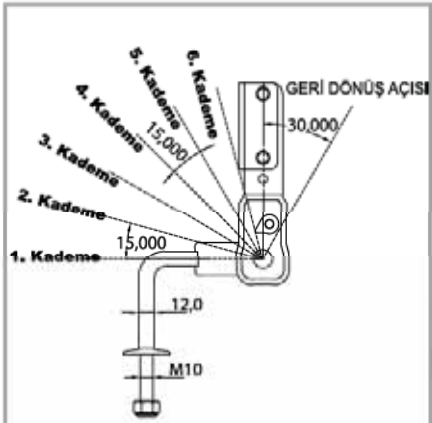
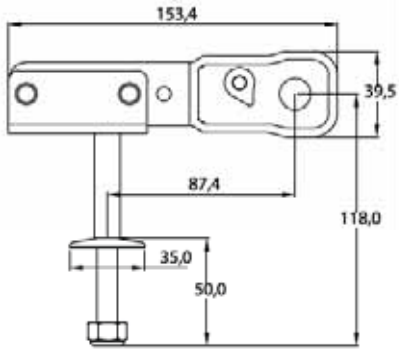

- Koltuklarda baş kısmının 15 derecelik açılarla 6 kademe de açılarak boyun kısmına destek veren mekanizmadır.
- Headpiece Mechanism provides a support to neck part for couches by opening up with 15 degrees angles in 6 steps.

**M02010256 Ürün No/Prod. No: 6**  
**KÖŞE BİRLEŞTİRME (KROKODİL)**  
**JOINT CORNER (CROCODILE)**

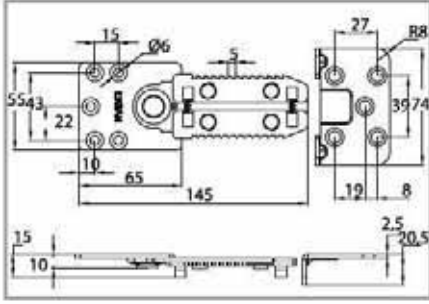

• Köşe takımlarında ayarlanabilir ara mesafesi ile iki koltuğu birbirine kolaylıkla birleştirebilen mekanizmadır. Farklı kumaş, deri gibi döşemelerde dahi kolaylık sağlar. Taşıma esnasında ve kullanılmadığında sağa veya sola döndürülerek gizlenir.

• Joint Corner mechanism joints two couches of the corner units by adjustable space distance. It provides easiness even in leather upholstery or different kind of fabric upholsteries. It can be concealed when in need of carriage or in nonuse.

**M02010411 Ürün No/Prod. No: 7**  
**SIRT HAREKET MEKANİZMASI**  
**BACK MOTION MECHANISM**

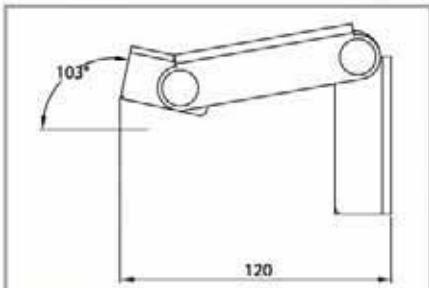
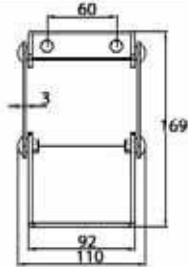

• Koltukların sırt fontunun ileri geri hareketiyle daha geniş oturma alanı sağlayan mekanizmadır.

• Back Motion Mechanism provides a wider sitting area by moving the backrest part forward and backward of the couches.



M02010412 Ürün No/Prod. No: 142  
SIRT ÇEKME MEKANİZMASI  
PULL BACK MECHANISM

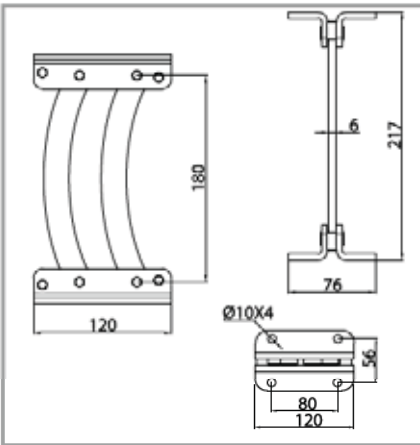
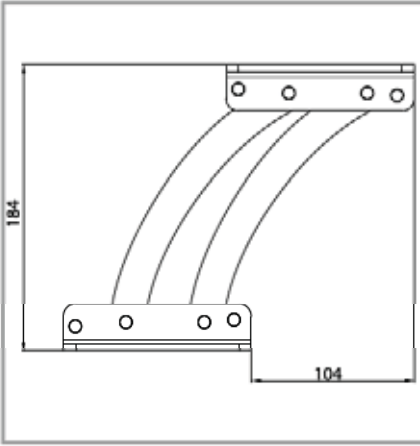
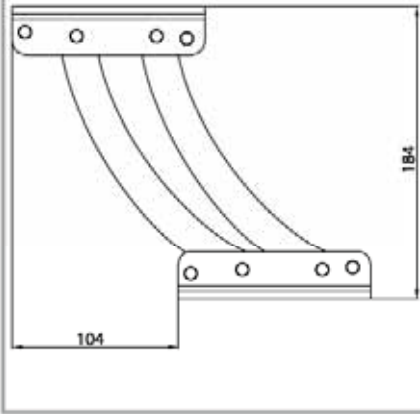

• Koltukların sırt fontunu ileri ve geri hareket ettirerek oturma ve dinlenme pozisyonları sağlayan mekanizmadır. Yaklaşık 22 cm kadar sırt fontuna hareket sağlar.

Not: Mekanizmanın dikey pozisyonundan 11 cm ileriye ve geriye hareket ettirir.

• Pull Back Mechanism provides resting and sitting position by moving forward and backward of the armchair's backrest part. It provides a motion to the backrest part approximately 22 cm.

P.S: The mechanism gives a motion of 11 cm. to backward and forward from its vertical position.

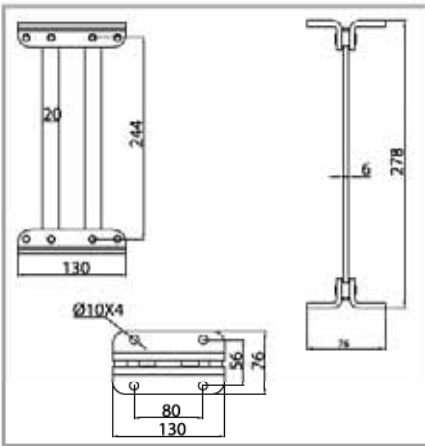
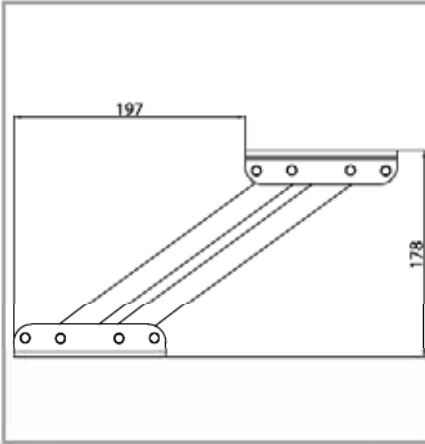
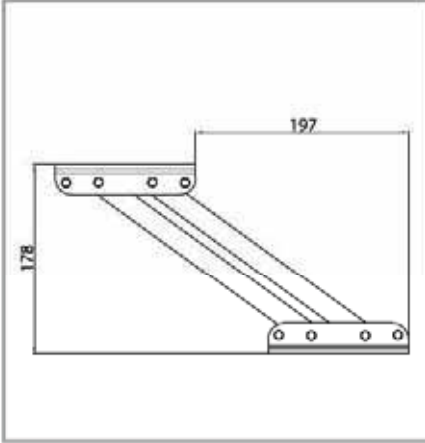

- Koltukların sırt fontunu ileri ve geri hareket ettirerek oturma ve dinlenme pozisyonları sağlayan mekanizmadır. Yaklaşık 40 cm kadar sırt fontuna hareket sağlar.

Not: Mekanizmanın dikey pozisyonundan 20 cm ileriye ve geriye hareket ettirir.

- Pull Back Mechanism with straight arms provides resting and sitting position by moving forward and backward of the armchair's backrest part. It provides a motion to the backrest part approximately 40 cm.

P.S: The mechanism gives a motion of 20 cm. to backward and forward from its vertical position

M02010225 Ürün No/Prod. No: 12  
KADEMELİ KOL MEKANİZMASI (8 KADEME)  
ARM STEP MECHANISM (8 STEPS)

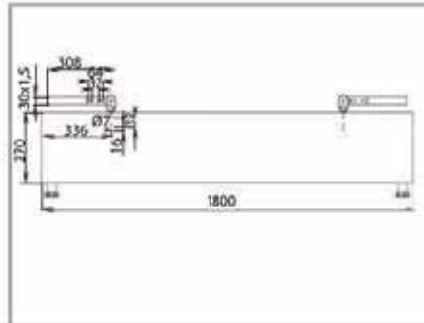
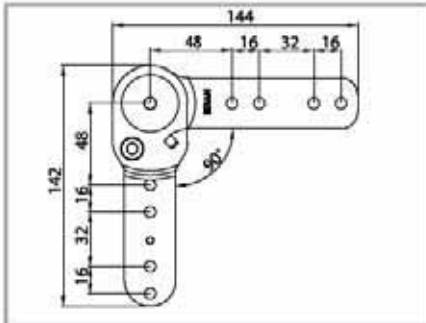
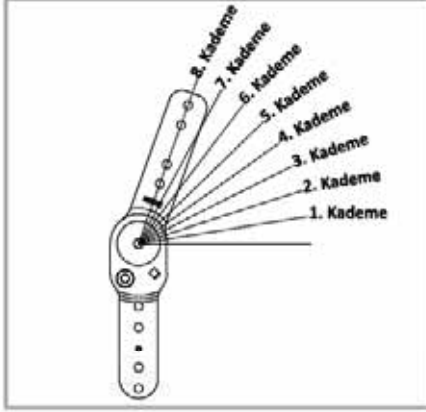

• Koltukların kol ve baş kısımlarını 9 derecelik açılarla 8 kademede hareket ettirerek farklı kademelerde kullanılmasını sağlayan fonksiyonel mekanizmadır.

• Arm Step Mechanism (8 Steps) is a functional mechanism that provides to move the headrest and the armrest parts of armchairs and couches with 9 degree angles in 8 steps

• Kanepelerde kolların 3 farklı açıda katlanarak ergonomik uzanma ve yatma özelliği sağlayan mekanizmadır.

• Arm step mechanism (3 steps) provides ergonomic resting and lying down features by collapsing in three different angles.

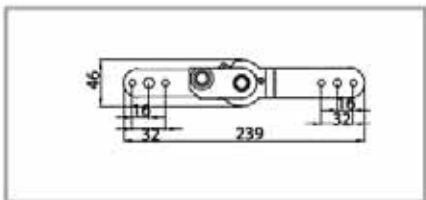
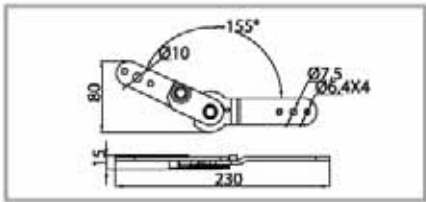
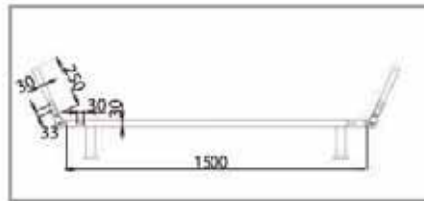
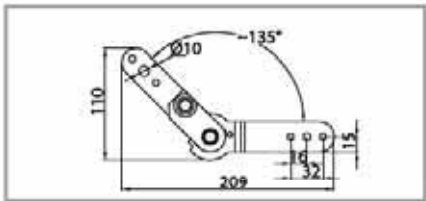
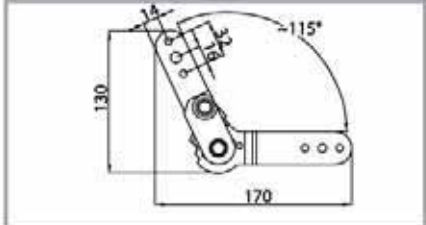

M02010222 Ürün No/Prod. No: 8  
KADEMELİ KOL MEKANİZMASI (3 KADEME)  
ARM STEP MECHANISM (3 STEPS)



M02010220 Ürün No/Prod. No: 26  
KATLAMA MEKANİZMASI (BOŞ)  
ARM CONTROL MECHANISM (EMPTY)

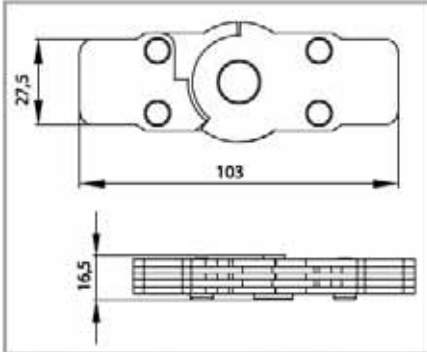
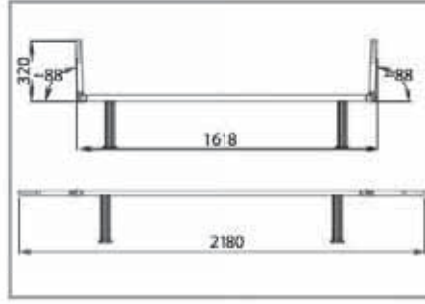
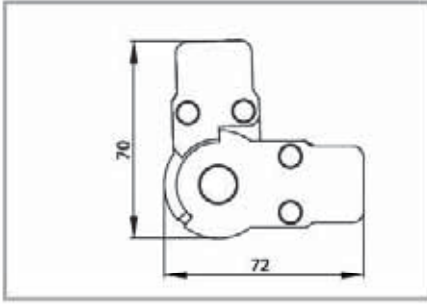

- Katlama mekanizması dolu ile birlikte kullanılır. Menteşe vazifesi görerek kolçak hareketine destek olur.
- Arm control mechanism (empty) is used with Arm Control Mechanism (full). It works as a hinge in order to support the armrest movement

- Kanepelerin kolçak kısmında kullanılan kutu profilin içine girecek ve kaynakla montajı yapılacak şekilde dizayn edilmiştir. Kolçağa 2 farklı açı pozisyonu sağlayan mekanizmadır.
- Arm control mechanism (full) is designed to be placed into the box profile and mounted by welding, which are used in the armrests of the couches. It provides moving the armrest in two different positions.

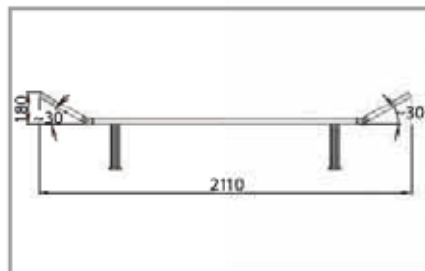
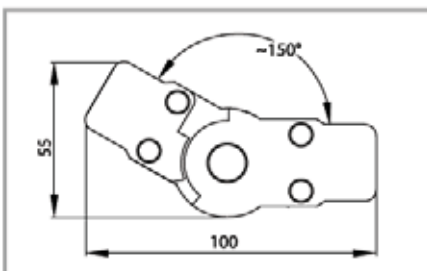
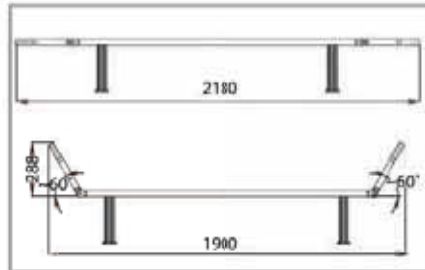
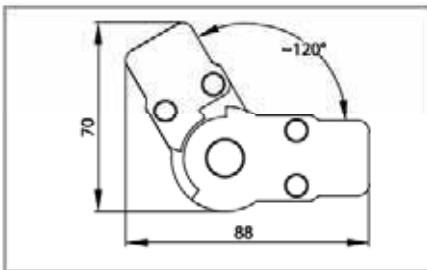
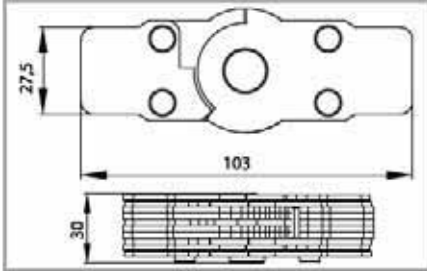

M02010430 Ürün No/Prod. No: 15  
SEHPA MEKANİZMASI  
COFFEE TABLE MECHANISM

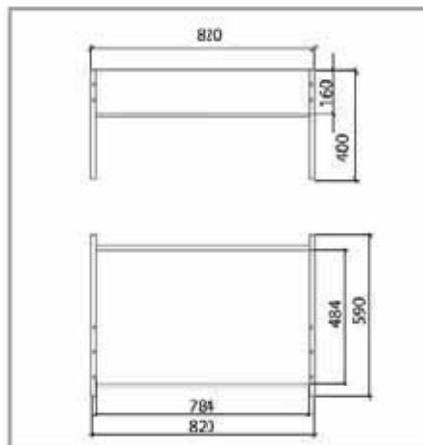
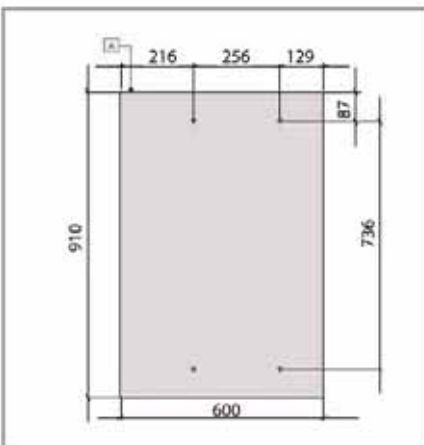
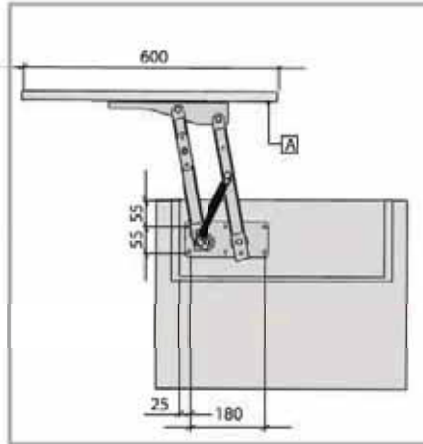
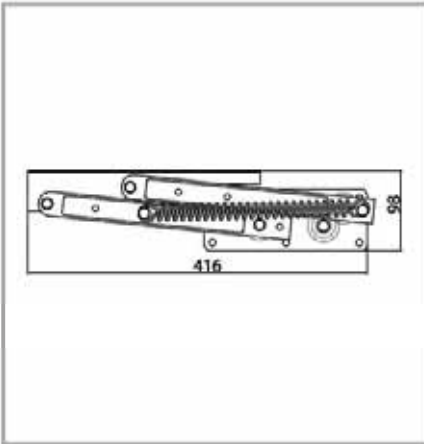
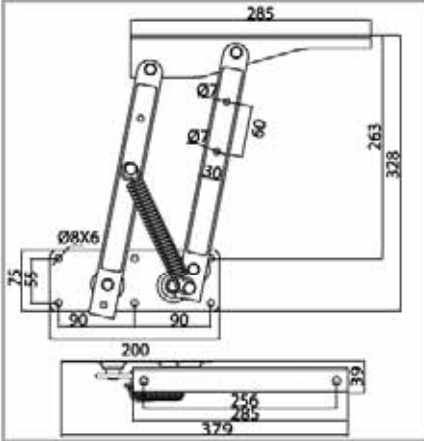

• Sehpaların üst kısmının öne ve yukarı doğru 23cm kadar hareket ettirilerek servis sehpası olarak kullanımını sağlar. Tasarıma göre tekli, ikili veya üçlü şekilde açılacak sehpaların yapılmasına olanak verir. Sehpanın iç kısmı sandık olarak kullanılabilir.

• Coffee table mechanism provides to move about 23 cm. forward and upward to the upper part enabling to be used as a service table. It allows producing coffee tables single, double and triple opening depending on the design. The inner side of the coffee table can be used as a case.

**M02010432 Ürün No/Prod. No: 16**  
**SEHPA MEKANİZMASI (AMORTİSÖRLÜ)**  
**COFFEE TABLE MECHANISM (GAS SPRING)**



Mekanizmanın ölçülendirmesi  
M02010430 kodlu Sehpa Mekanizması  
ile aynıdır.

The sizes of mechanism are same with  
the coffee table mechanism which is  
M02010430



• Sehpaların üst kısmının öne ve yukarı doğru 23 cm kadar hareket ettirilerek servis sehpa olarak kullanımlarını sağlar. Tasarıma göre tekli, ikili veya üçlü şekilde açılacak sehpaların yapılmasına olanak verir. Sehpaların iç kısmının sandık olarak kullanılmasına olanak verir. Gazlı amortisör yardımı ile kapının daha yumuşak şekilde açılıp kapanmasını sağlar.

• Coffee table mechanism (with gas spring) provides to move about 23 cm. forward and upward to the upper part enabling to be used as a service table. It allows producing coffee tables single, double and triple opening depending on the design. It secures a softened closure with the assistance of a gas spring.



M02010441 Ürün No/Prod. No: 19  
MASA MEKANİZMASI (OTOMATİK)  
TABLE MECHANISM (AUTOMATIC)

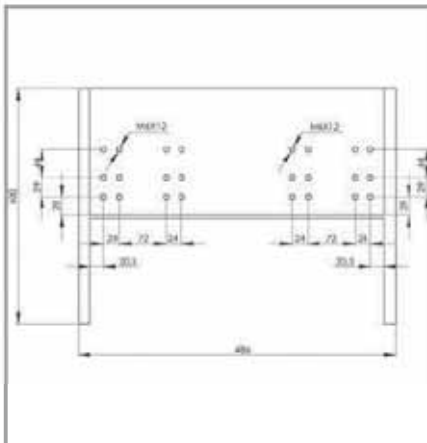
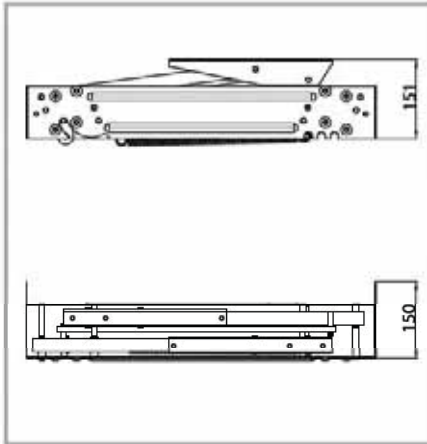
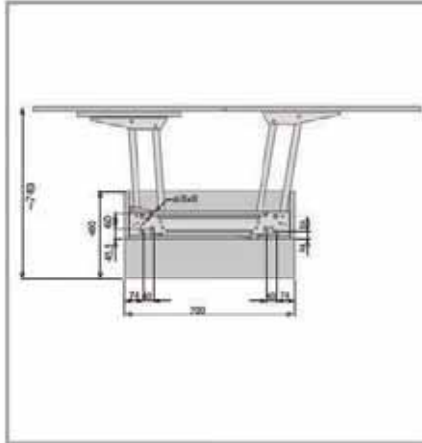
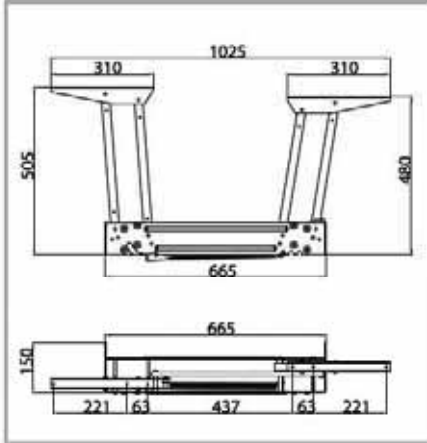

• Sehpaların (80\*80 veya 90\*90) cm ölçülerinde yemek masası olarak kullanılmasını sağlar. Üst kapağın yukarı doğru çekilmesi ile mekanizma açılır ve üst kapak menteşeli kısmından, içeriden otomatik olarak açılan küçük kapağın üstüne yatırılır. 160x80 veya 180x90cm ölçülerinde yerden 74cm kadar yükseklikte yemek masası haline dönüşür.

• Table mechanism automatic (80x80 or 90x90) provides to be used as a dining table. The mechanism opens up by pulling up the upper cover and putting it down to the smaller cover which automatically comes from inside of the box. It becomes a dining table with a measurement of 160x80 or 180x90 and with a height of about 74 cm. From the floor.

M02010900 Ürün No/Prod. No: 20  
DÖNER KOLTUK  
SWIVEL CHAIR

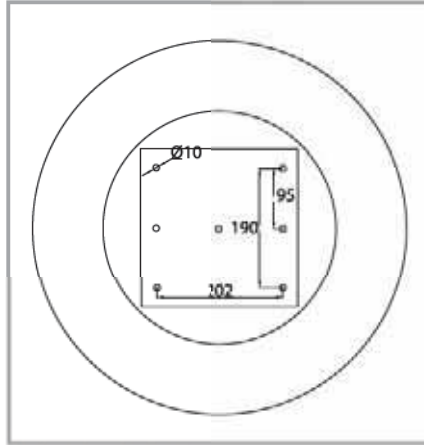
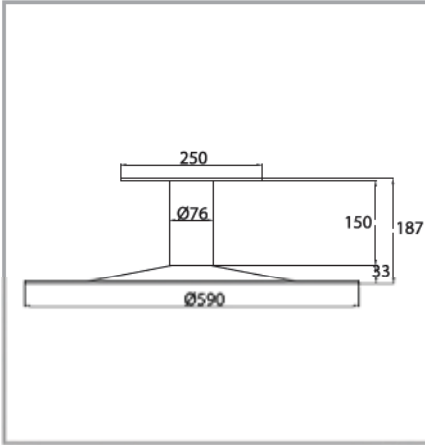

- Berjer altlarında kullanılır.Boşluk yapmayacak şekilde çift rulmanlı olarak 360 derece serbest dönebilir.
- Swivel chair is used in the bottom of the bergere. It can turn 360 degress by double ball bearing without causing a margin.

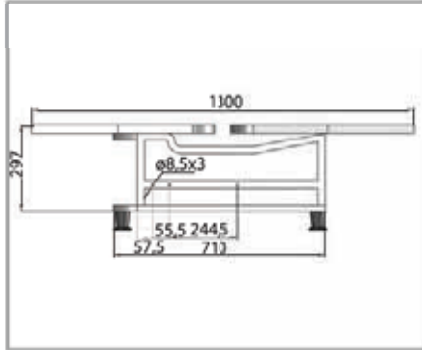
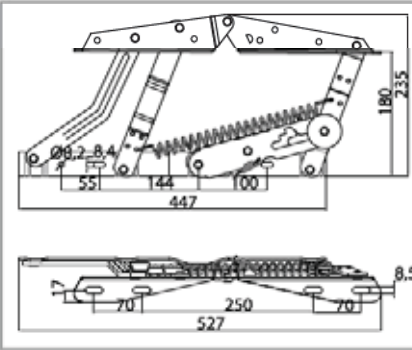
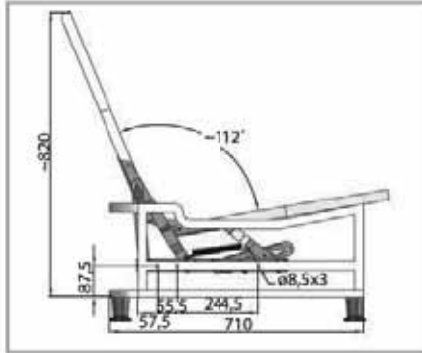
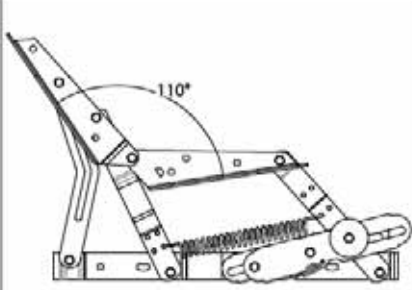
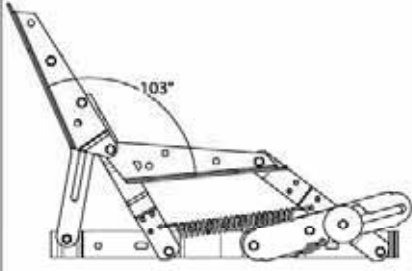

• Kanepelerin sırt fontunun yukarıdan bastırarak oturma, dinlenme ve yatak pozisyonuna getiren mekanizmadır. Sırt kısmından hareket ettirilerek oturma pozisyonuna getirilir.

• Eks. Mechanism provides sitting, resting and bed features to the coudues by applying pressure from the up. Sitting position is acquired when moved from the back side.



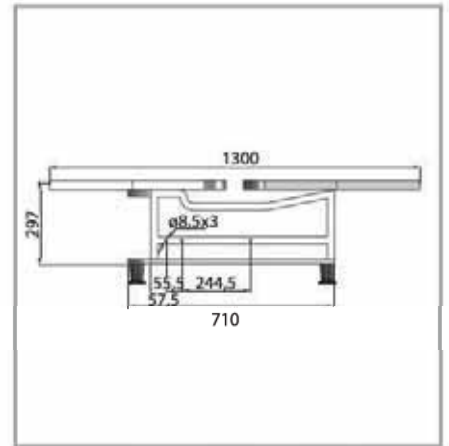
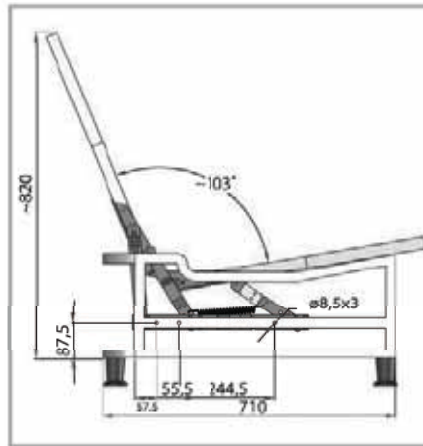
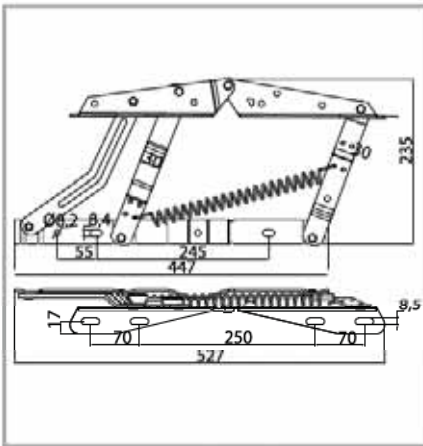
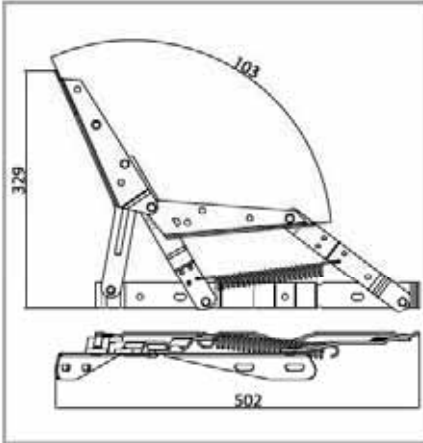

• Kanepelerin sırt fontunun yukarıdan bastırarak oturma pozisyonundan yatak pozisyonuna getiren mekanizmadır. Sırt kısmından hareket ettirilerek oturma pozisyonuna getirilir.

• Eks. mechanism (unbarred) provides the couches transform from sitting position to bed position by applying pressure from the up. Sitting position is acquired when moved from the back side.

M02010162 Ürün No/Prod. No: 25  
EKS MEKANİZMASI (ÖNDEN AÇILAN)  
EKS MECHANISM (DROPDOWN FRONT)

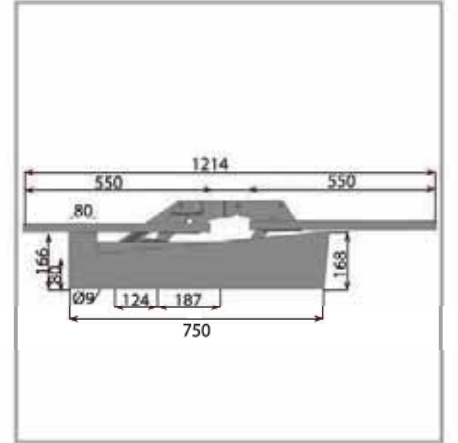
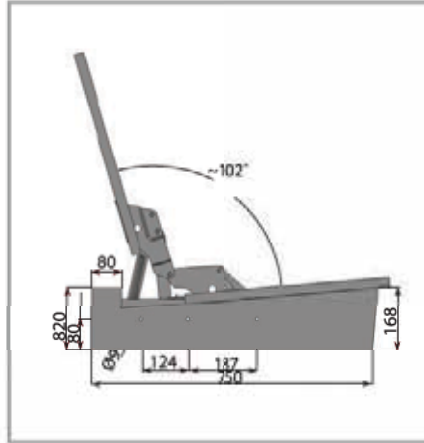
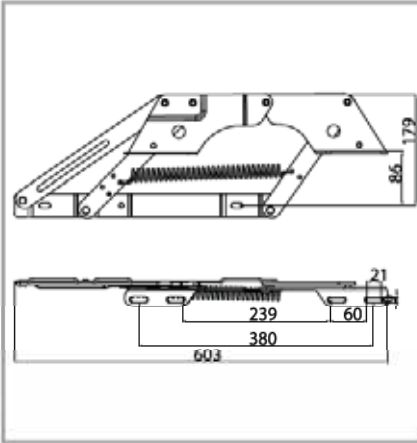
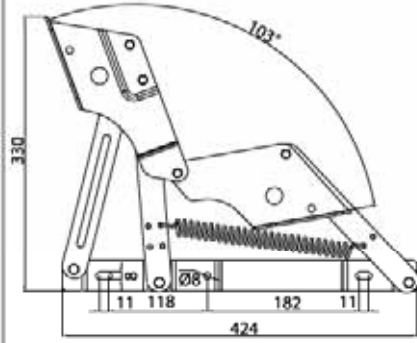

• Kanepenin hem sırt fontundan bastrarak hemde önden çekerek yatak olmasını sağlayan mekanizmadır. Yine sırttan veya önden kaldırarak oturma pozisyonuna getirilir.

• Eks. Mechanism (dropdown front) provides the couches transform into a bed by both pressing to the backrest front or pulling from the front. Sitting position is acquired back again from either frontal or backwards lifting.

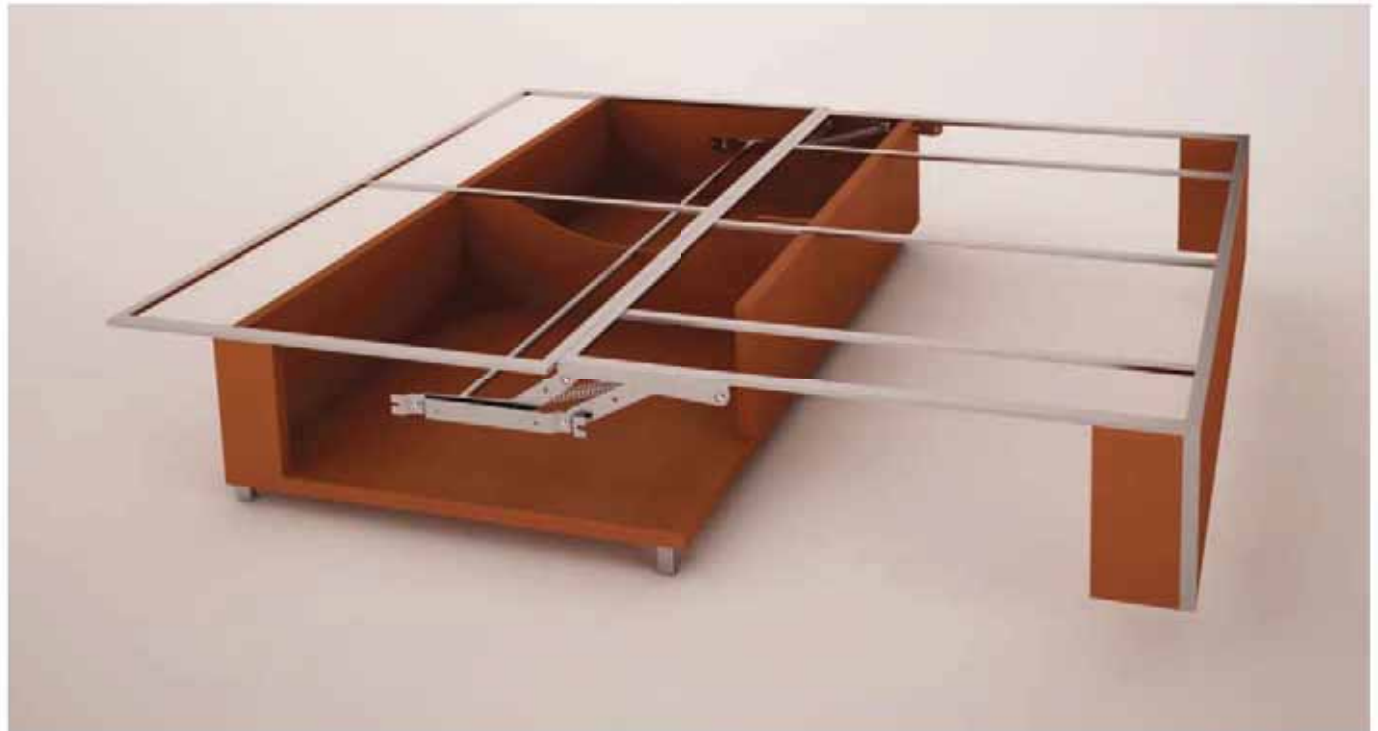
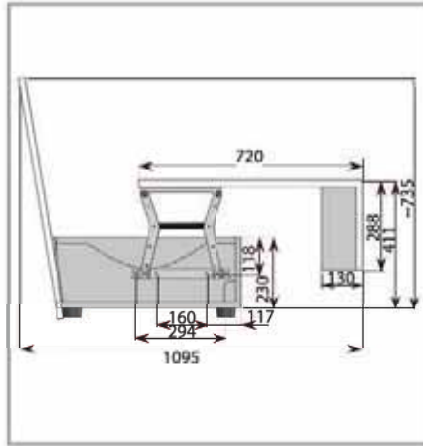
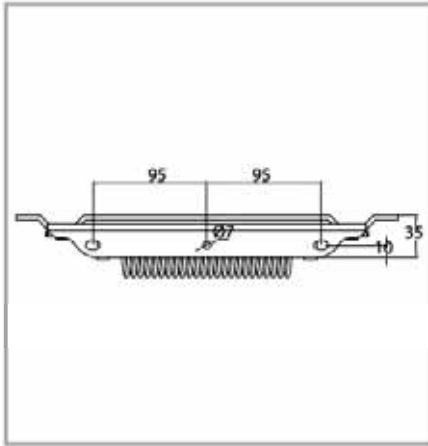
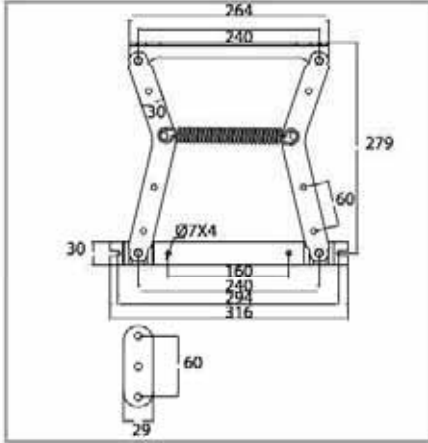

• Köşe takımlarında,iki ve üç kişilik kanepelerde kullanılan oturma fontunun yukarı kaldırılarak öne doğru gelmesini sağlayan, sırt fontununda yatırılarak yatak olmasını sağlayan mekanizmadır.

• Mattress mechanism provides to become forward by pulling the sitting part up and also provides to be used as a bed by laying down the back part of the corner set or double and triple couches.



M02010421 Ürün No/Prod. No: 31  
SOMYA MEKANİZMASI (KISA KOLLU)  
MATTRESS MECHANISM (SHORT ARMED)

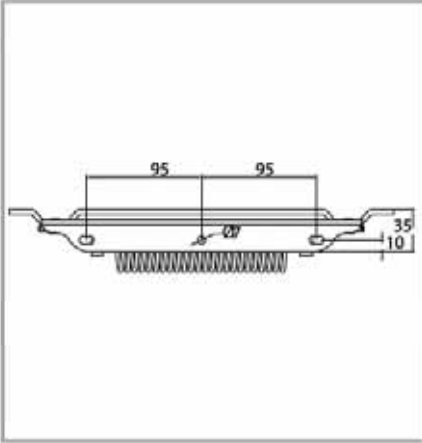
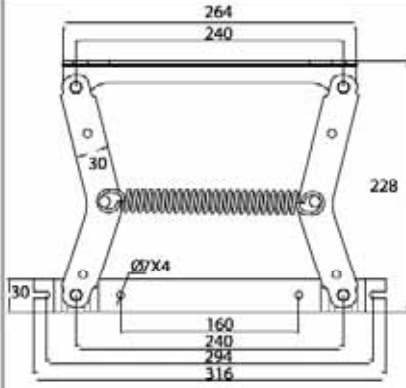

• Köşe takımlarında,iki ve üç kişilik kanepelerde kullanılan oturma fontunun yukarı kaldırılarak öne doğru gelmesini sağlayan, sırt fontununda yatırılarak yatak olmasını sağlayan mekanizmadır.

• Mattress mechanism (short armed) provides to become forward by pulling the sitting part up and also provides to be used as a bed by laying down the back part of the corner set or double and triple couches.

M02010150 Ürün No/Prod. No: 34

MELTEM MEKANİZMASI

MELTEM MECHANISM

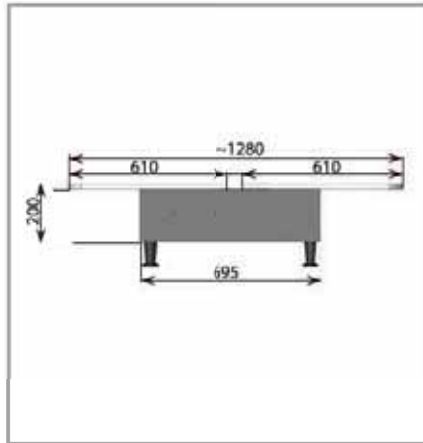
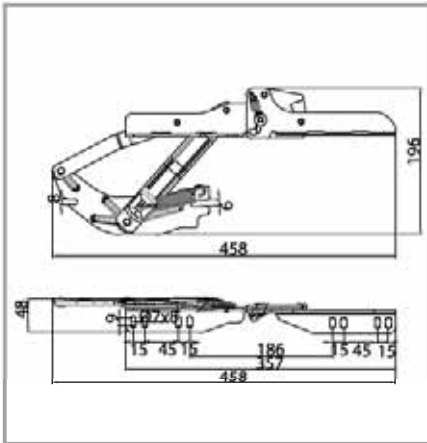
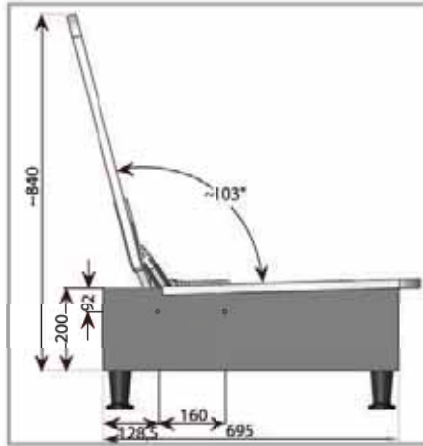
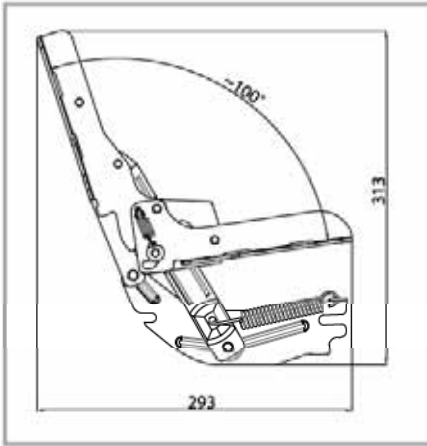
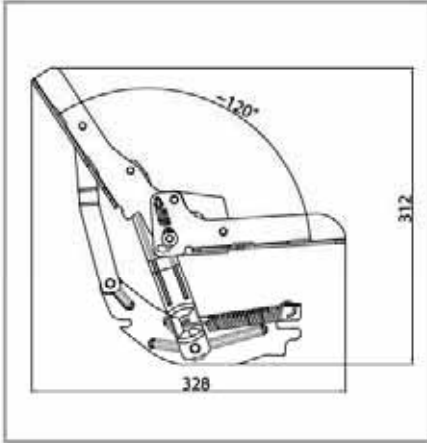

- Kanepelere sırt fontuna iki ayrı açıda oturma ve yatak olabilme özelliği sağlayan mekanizmadır. Tekli, ikili ve üçlü kanepelerde kullanılabilir.
- Meltem mechanism provides two different sitting positions to the backrest part in two different angles and also provides a bed position. It could be used in single, double and triple couches.

M02010150-1 Ürün No/Prod. No: 109  
MELTEM MEKANİZMASI (KOLSUZ)  
MELTEM MECHANISM (WITHOUT ARM)

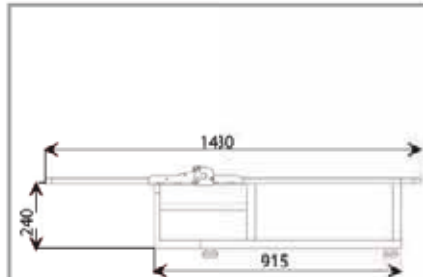
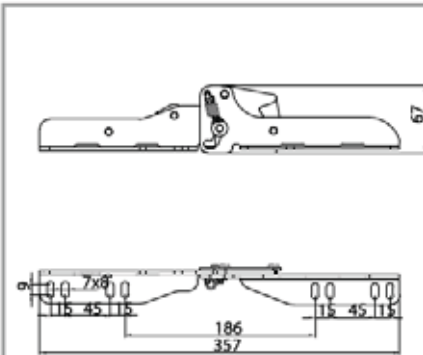
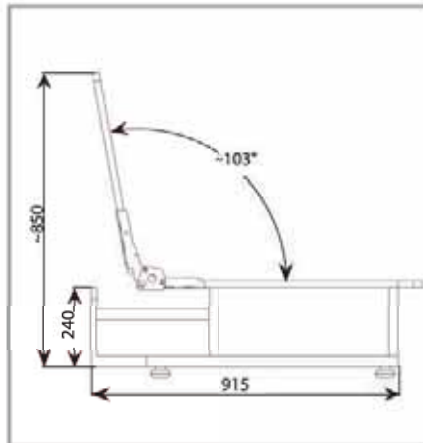
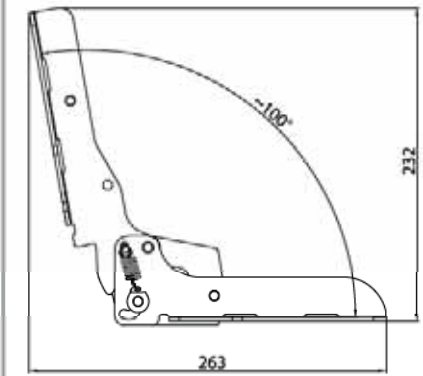
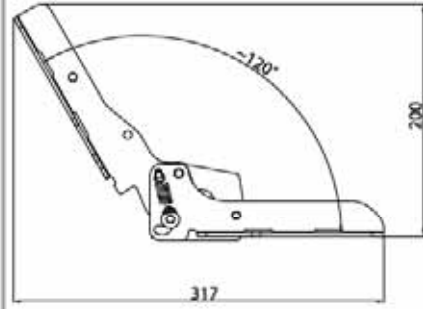

- Kanepelerin sırt fontuna iki ayrı açıda oturum ve yatak olabilme özelliği sağlayan mekanizmadır. Tekli ve ikili kanepelerde kullanılır.
- Meltem mechanism (without arm) provides two different sitting positions to the backrest part in two different angles and also provides a bed position. It could be used in single and double couches.

M02010320 Ürün No/Prod. No: 32

YENİ MELTEM MEKANİZMASI

NEW MELTEM MECHANISM

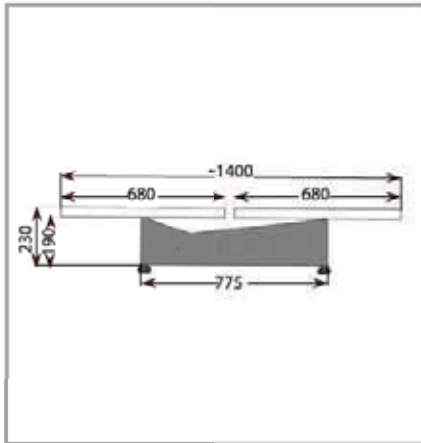
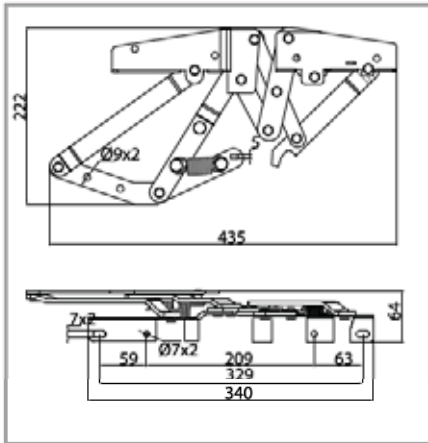
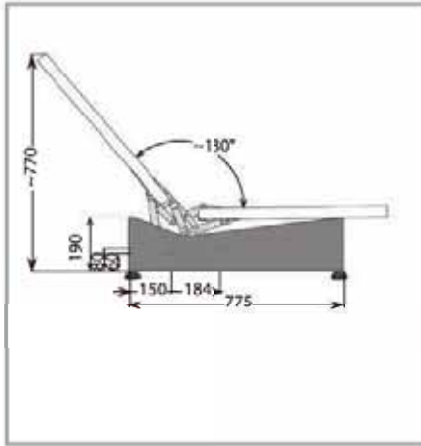
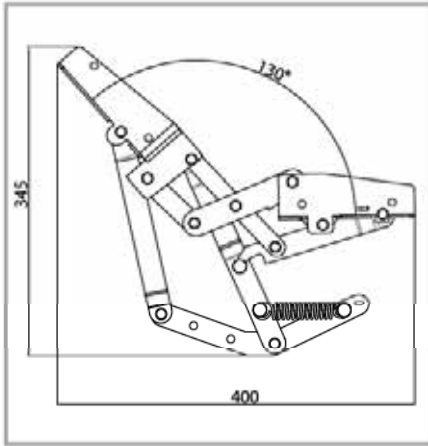
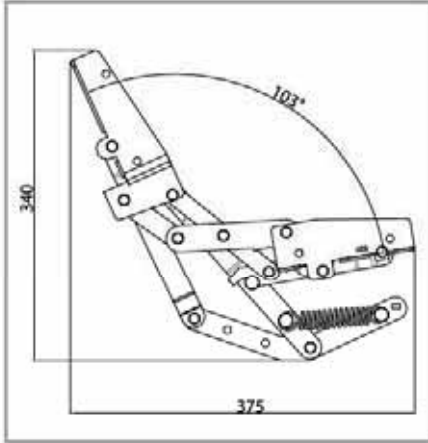

• Kanepelere sırt fontuna iki ayrı açıda oturma ve yatak olabilmeye özelliği sağlayan mekanizmadır. Tekli, ikili ve üçlü kanepelerde kullanılabilir. Mekanizma oturma pozisyonunda sünger sıkışmasını engeller. Yatak pozisyonunda ise sünger boşluğunu kapatacak şekilde tasarlanmıştır.

• New meltem mechanism provides two different sitting positions to the backrest part in two different angles and also provides a bed position. It can be used in single double and triple couches. The mechanism prevents the foam being stuck while in sitting position. If in bed position the mechanism is designed to cover the foam space.



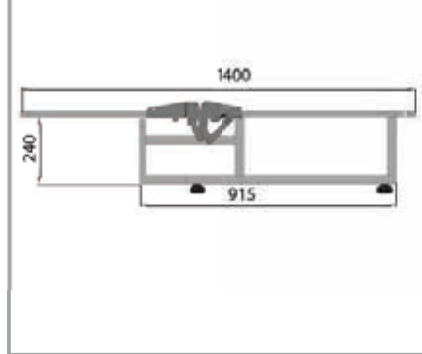
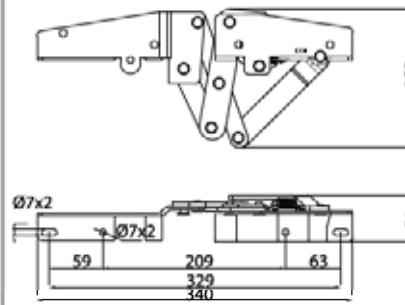
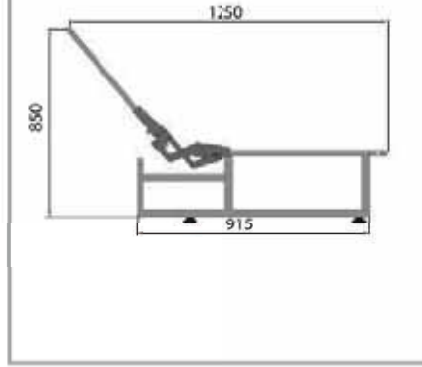
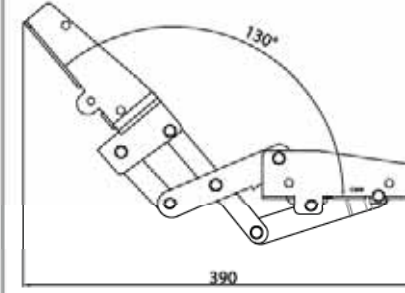
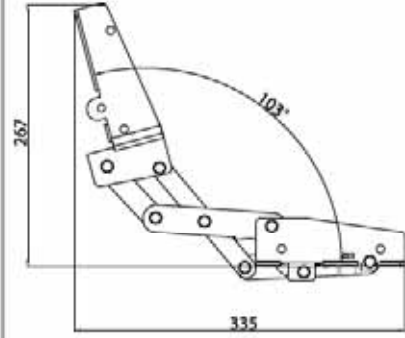

• Kanepelerin sırt fontuna iki ayrı açıda oturma ve yatak olabilme özelliği sağlayan mekanizmadır. Tekli ve ikili kanepelerde kullanılır. Mekanizma oturma pozisyonunda sünger sıkışmasını engeller. Yatak pozisyonunda ise sünger boşluğunu kapatacak şekilde tasarlanmıştır.

• New meltem mechanism (without arm) provides two different sitting positions to the backrest part in two different angles and also provides a bed position. It can be used in single double and triple couches. The mechanism prevents the foam stuck while in sitting position. If in bed position the mechanism is designed to cover the foam space.

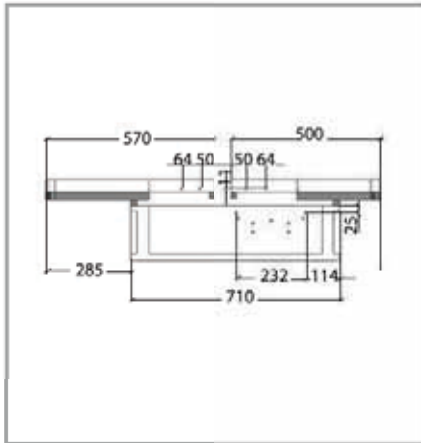
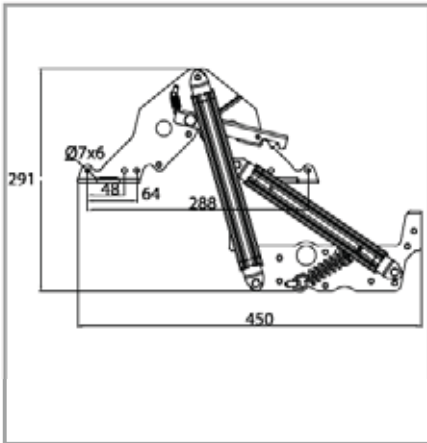
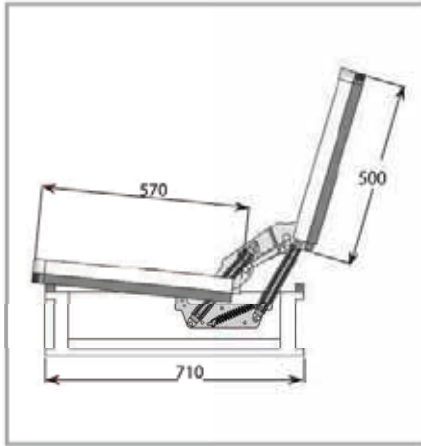
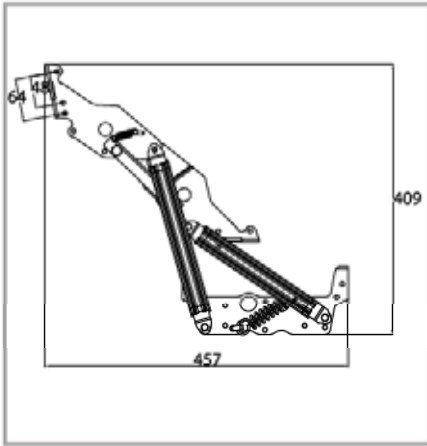
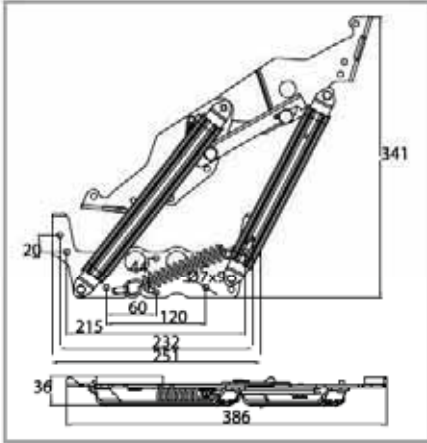

• Profil ve ahşap iskeletli kanepelerde kullanılan kanepenin oturma pozisyonundan sandık ve yatak haline dönüşümünü sağlayan mekanizmadır. Kanepeler sandık ve yatak haline geçerken duvarla arasındaki mesafeyi açmak için öne doğru çekilmesine gerek yoktur.

• Super japon mechanism provides to become a bed and a case from sitting position in profile or wooden skeleton couches. There is no need to pull the couch from the wall to transform into couch, bed or case mode.

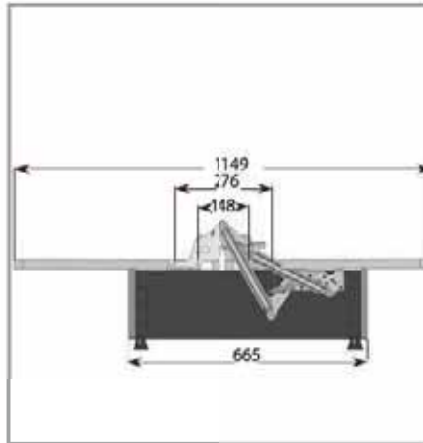
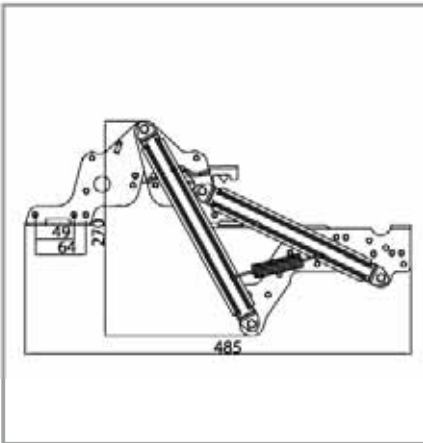
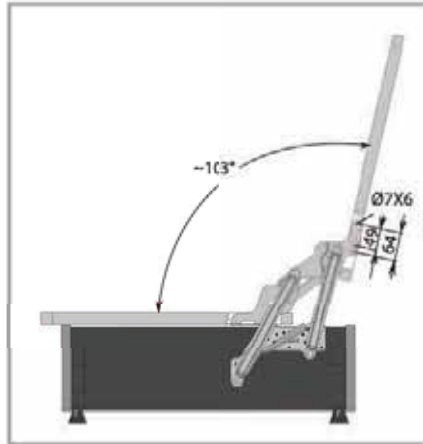
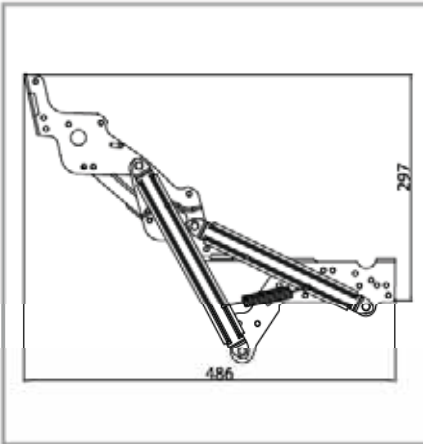
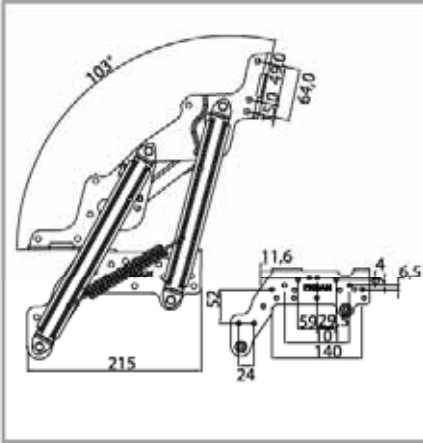

• Büyük japon mekanizmaların kasalarında bire bir kullanılarak kanepeye duvardan sıfır açılma özelliği katan mekanizmadır. Mekanizma profillere ve alt kasaya büyük japon mekanizmalarındaki bağlantı delikleri kullanılarak bağlanır. Alt kasaya sadece bir adet delik eklenmesi gerekmektedir. İç tarafta çalışan kilitleme dili sistemi ile profil kenar çıtası kesme gerekliliğini ortadan kaldıran işçilik ve maliyet avantajı sağlayan mekanizmadır. Tekli, ikili ve üçlü gibi kanepe modellerinde kullanılır.

• Super japon mechanism (midi) can be used in big japon mechanism down cases and gives a speciality to open up without pulling back from wall. The mechanism mounts to profiles and down cases, using the big japon mechanism's connection holes. Just one hole has to be added to under case. The mechanism provides workmanship and margin advantage with the locking bolt system that works inside and doesn't require to cut side profile strip. The mechanism is in use for single, double and triple couches.

M02010107 Ürün No/Prod. No: 405  
MAXI JAPON MEKANİZMASI  
MAXI JAPON MECHANISM

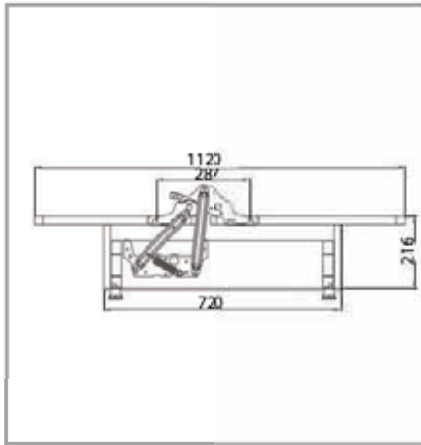
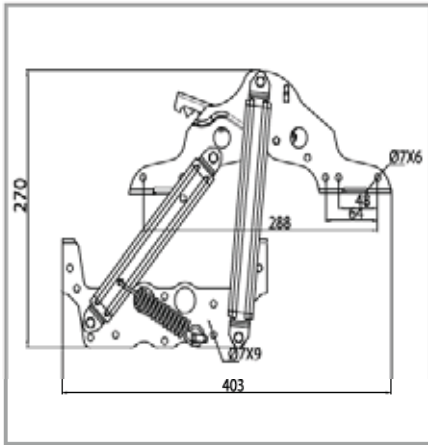
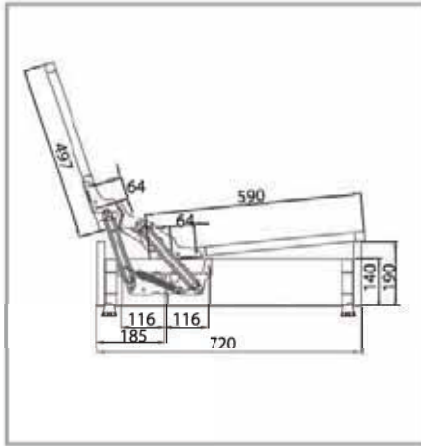
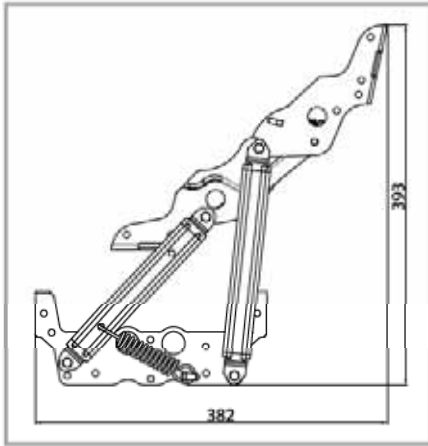
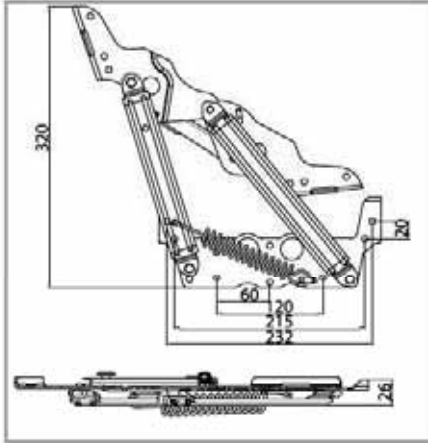

• 25 lik kutu profil ile kullanılabilen duvara sıfırdan açılabilen mekanizmadır. Özellikle süngerli ürünlerde sünger kalınlığını en düşük seviyede kullanılması sağlayan sandık,yatak özelliği olan fonksiyonel mekanizmadır.İç tarafta çalışan kilitleme dili sistemi ile profil kenar çıtası kesme gerekliliğini ortadan kaldıran işçilik ve maliyet avantajı sağlayan mekanizmadır. Tekli, ikili ve üçlü gibi kanepe modellerinde kullanılır.

• Maxi Japon mechanism can be used with 25X25 profile and opens up without pulling back from wall. Especially foam included products,this functional mechanism provides to use the foam in minimum levels and it has a speciality to be a case and a bed.The mechanism provides workmanship and margin advantage with the locking bolt sytem that works inside and doesn't require to cut side profile strip..The mechanism is in use for single ,double and trible couches..



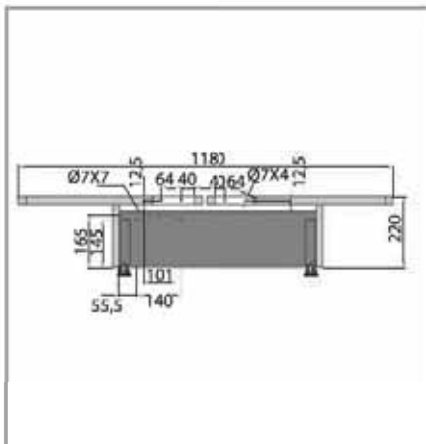
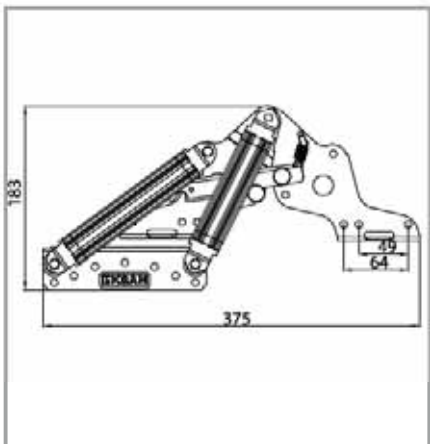
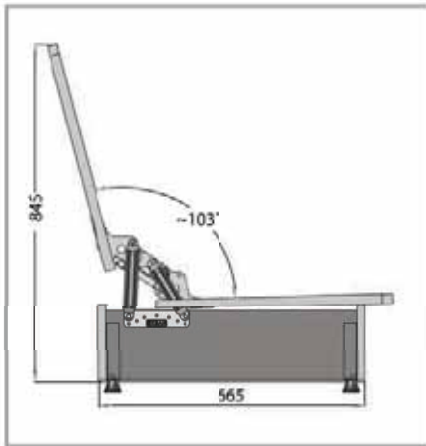
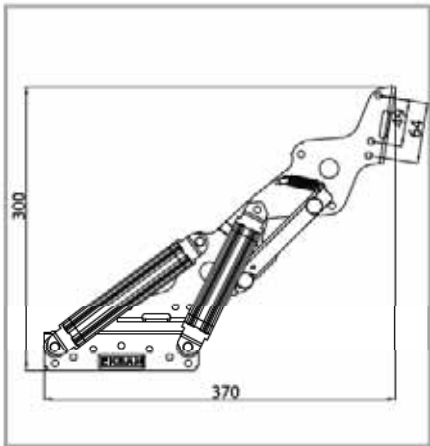

- 32

M02010101 Ürün No/Prod. No: 36  
YENİ BÜYÜK JAPON MEKANİZMASI  
NEW BIG JAPON MECHANISM

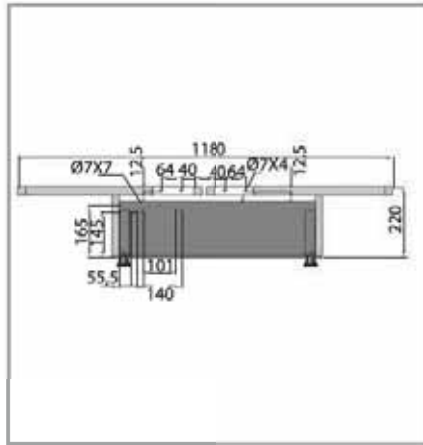
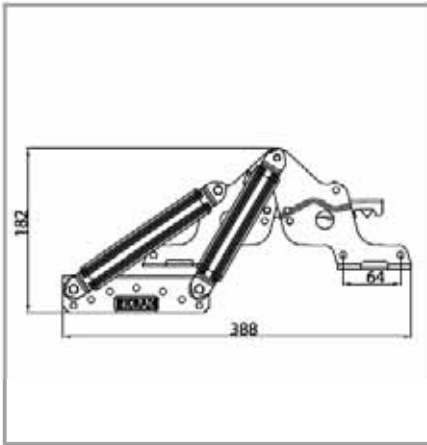
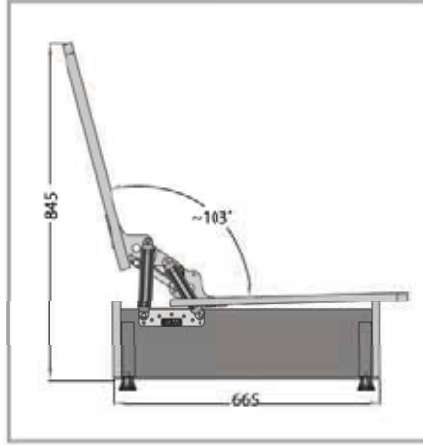
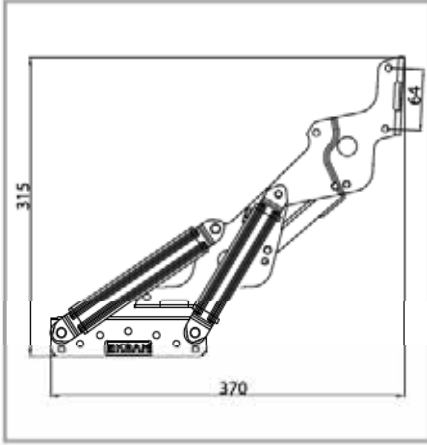
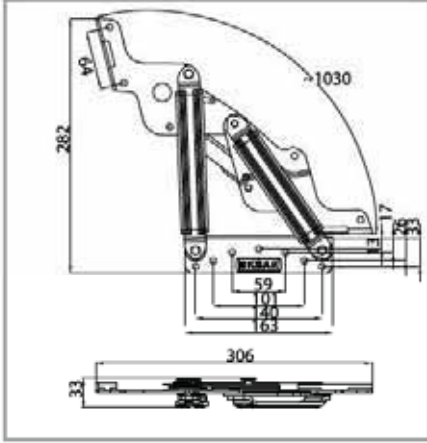

- Profil ve ahşap iskeletli kanepelerde kullanılan kanepenin oturma pozisyonundan sandık ve yatak haline dönüşümünü sağlayan mekanizmadır. İç tarafta çalışan kilitleme sistemi ile profil kenar çitası kesme gerekliliğini kaldırarak işçilik ve maliyet avantajı sağlayan mekanizmadır.
- New big japon mechanism provides to become a bed and a case from sitting position in profile and wooden skeleton couches. The mechanism provides workmanship and margin advantage with the locking bolt system that works inside and doesn't require to cut side profile strip.

**M02010103 Ürün No/Prod. No: 40**  
**BÜYÜK JAPON MEKANİZMASI (KOLSUZ)**  
**BIG JAPON MECHANISM (WITHOUT ARM)**

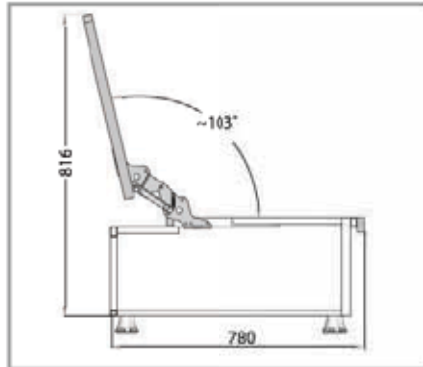
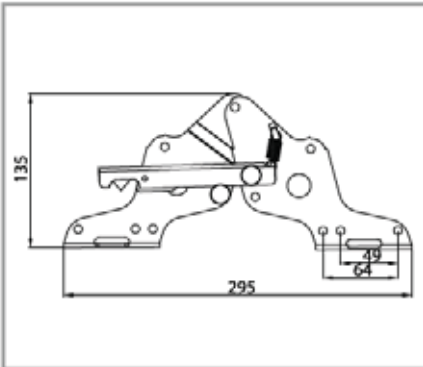
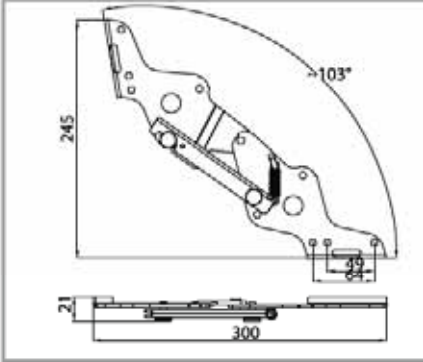

• Profil ve ahşap iskeletli kanepelerde sırt fontunu kaldırıp açmak suretiyle yatak olabilmeye özelliği sağlayan mekanizmadır.

• Big japon mechanism (without arm) provides to become a bed in profile and wooden skeletons by opening and lifting up the backrest part.

**M02010101-1 Ürün No/Prod. No: 38**  
**YENİ BÜYÜK JAPON MEKANİZMASI (KOLSUZ)**  
**NEW BIG JAPON MECHANISM (WITHOUT ARM)**

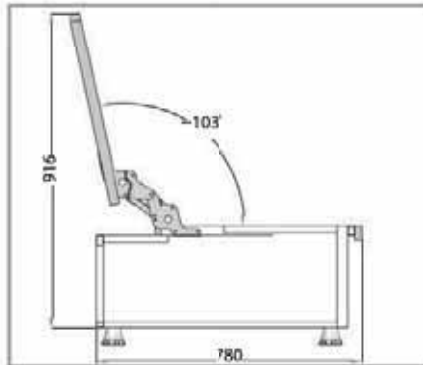
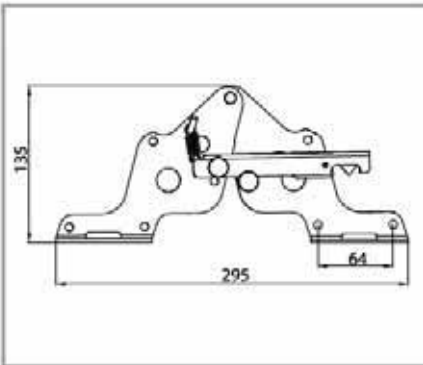
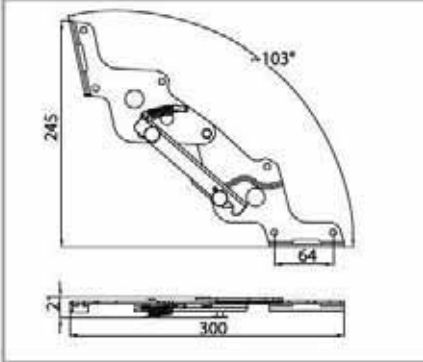

• Profil ve ahşap iskeletli kanepelerde sırt fontunu kaldırıp açmak suretiyle yatak olabilmeye özelliği sağlayan mekanizmadır.

• New big japon mechanism (without arm) provides to become a bed in profile and wooden skeletons by opening and lifting up the backrest part.

**M02010104 Ürün No/Prod. No: 41**  
**BÜYÜK JAPON MEKANİZMASI**  
**(3 KADEMELİ KOLSUZ)**  
**BIG JAPON MECHANISM**  
**(3 STEPS WITHOUT ARM)**

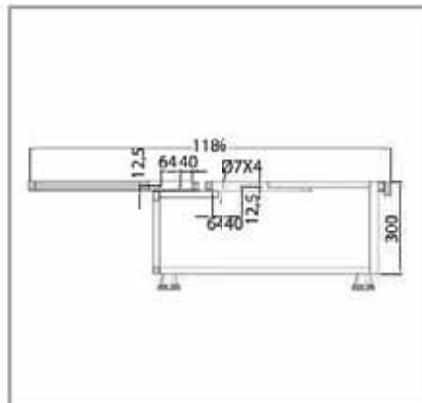
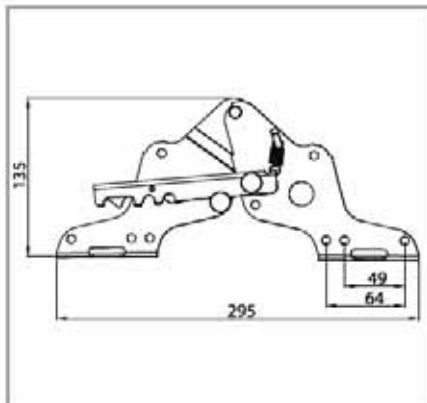
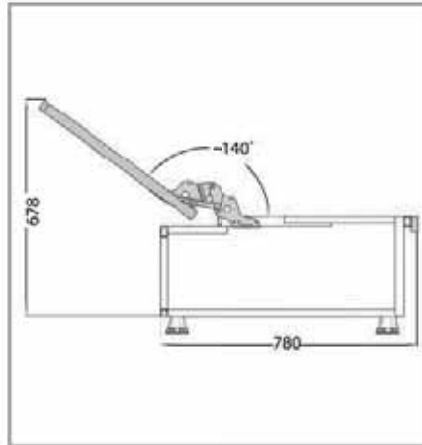
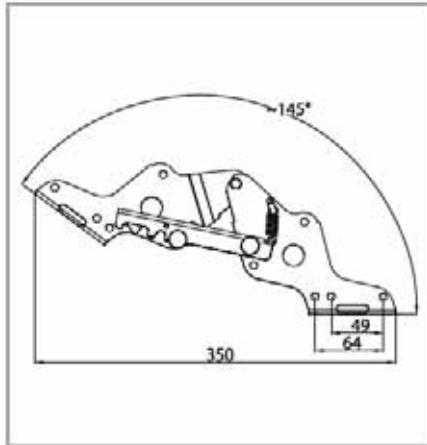
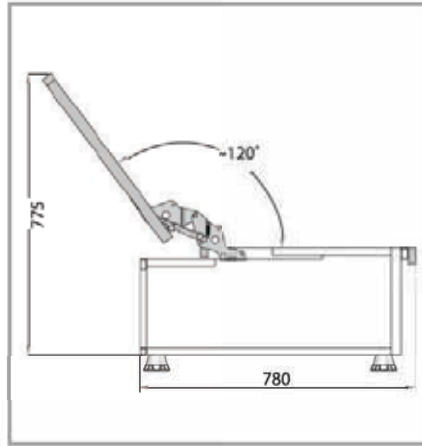
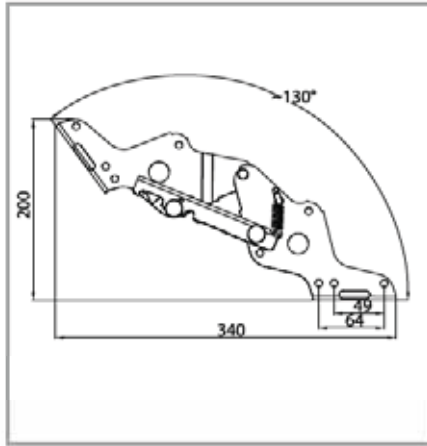
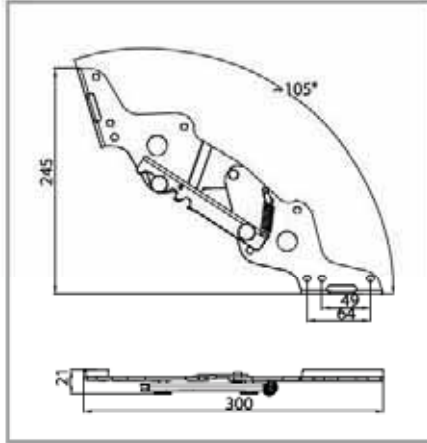

- Profil ve ahşap iskeletli kanepelerde sırt fontunun üç farklı açıda oturma rahatlığı ve yatak olabirme özelliği sağlayan mekanizmadır.
- Big Japon mekanizması (3 steps without arm) provides to give comfortable sitting and becomes a bed with 3 different angles in profile and wooden skeletons.



M02010101-2 Ürün No/Prod. No: 39  
YENİ BÜYÜK JAPON MEKANİZMASI  
(3 KADEMELİ KOLSUZ)  
NEW BIG JAPON MECHANISM  
(3 STEPS WITHOUT ARM)

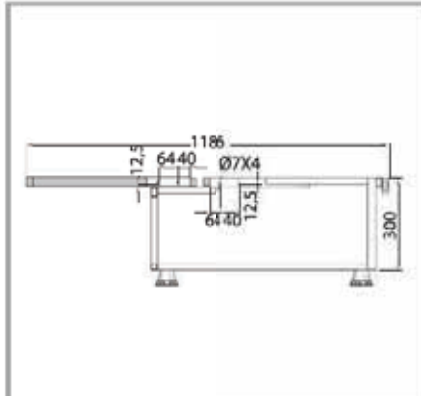
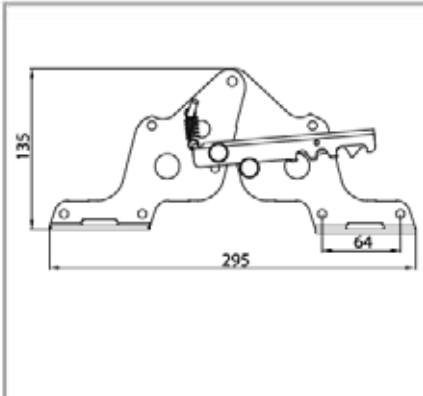
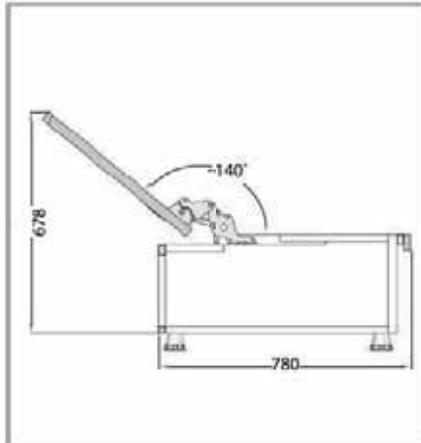
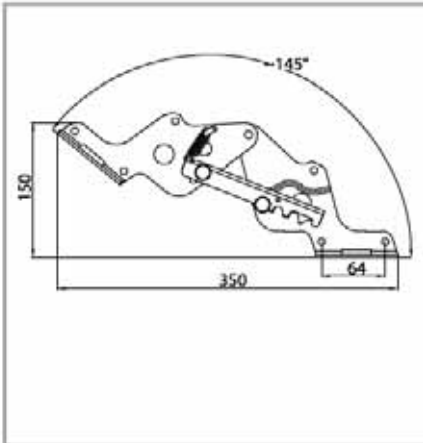
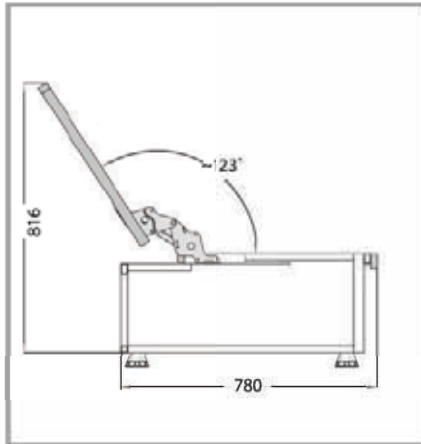
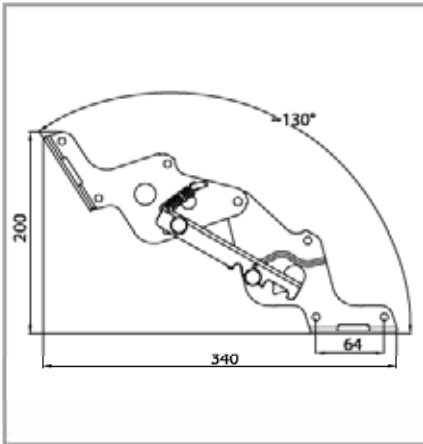
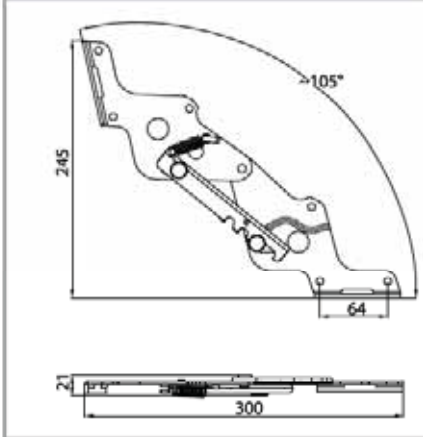

• Profil ve ahşap iskeletli kanepelerde sırt fontunu kaldırıp açmak suretiyle yatak olabilme özelliği sağlayan fonksiyonel mekanizmadır.

• New big japon mechanism (3 steps without arm) provides to give comfortable sitting and becomes a bed with 3 different angles in profile and wooden skeletons.

M02010410 Ürün No/Prod. No: 42  
SIRT MEKANİZMASI (2 KADEMELİ KOLSUZ)  
BACK MECHANISM (2 STEPS WITHOUT ARM)

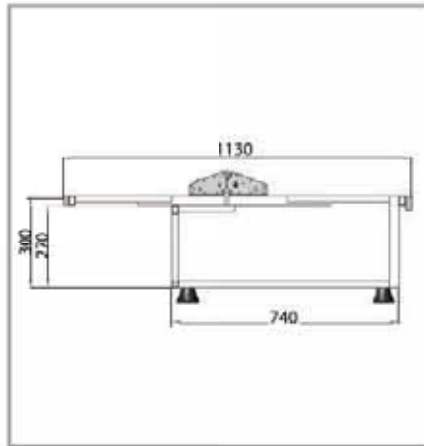
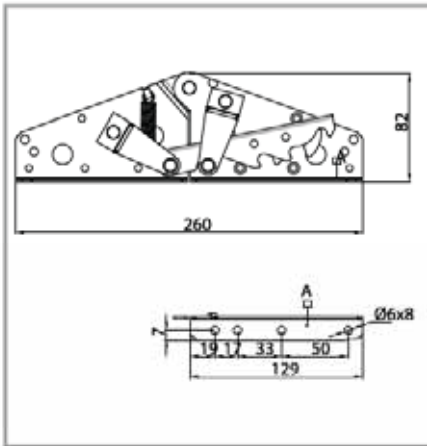
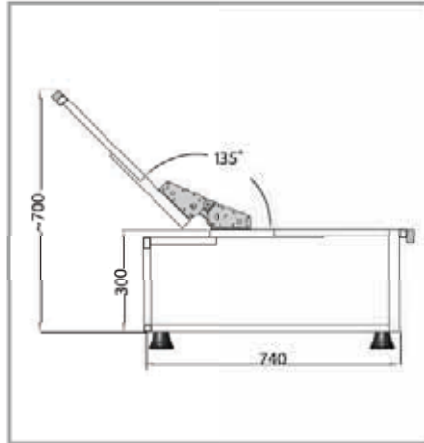
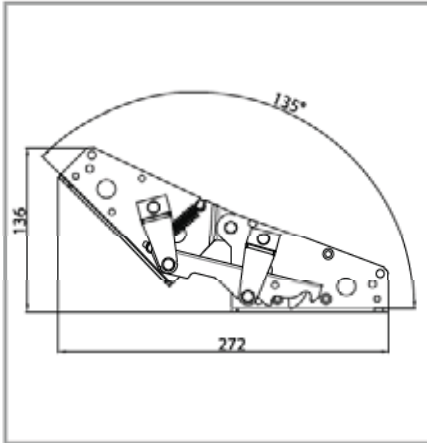
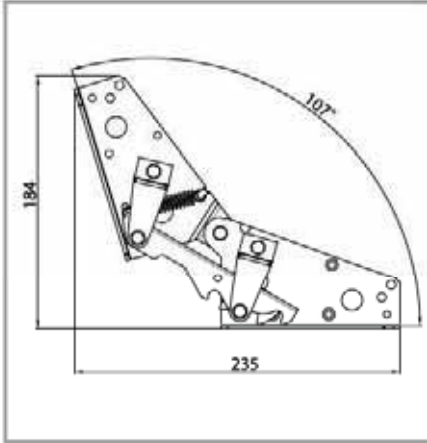

- Profil ve ahşap iskeletli kanepelerde sırt fontunun üç farklı açıda oturma rahatlığı ve yatak olabilme özelliği sağlayan mekanizmadır.
- Back mechanism (2 steps without arm) provides to give comfortable sitting and become a bed with 2 different angles in profile and wooden skeletons.

M02010142 Ürün No/Prod. No: 43  
AMORTİSÖRLÜ BAZA MEKANİZMASI  
BED MECHANISM

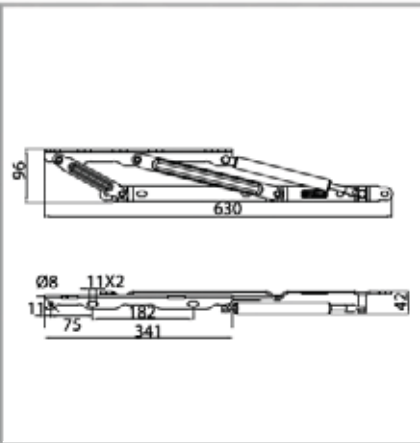
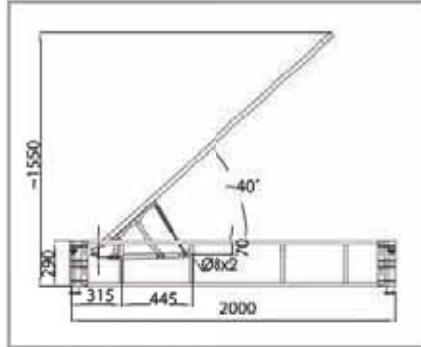
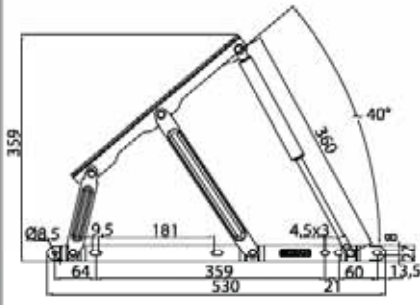

- Baza sistemli yataklarda kullanılır. Gazlı amortisör yardımı ile baza kapağının 40 derece açılmasını sağlar. 300 ve 1200 newton arasında gazlı amortisör kullanılır.
- Bed mechanism is in use in base system beds. By the support of gas spring the base cover can lift up to 40 degrees. It can be used in the midst of 300 and 1200 nw gas springs

M02010143 Ürün No/Prod. No: 45  
AMORTİSÖRLÜ BAZA MEKANİZMASI (Küçük)  
BED MECHANISM (Small)

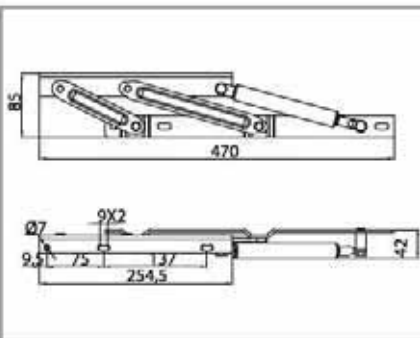
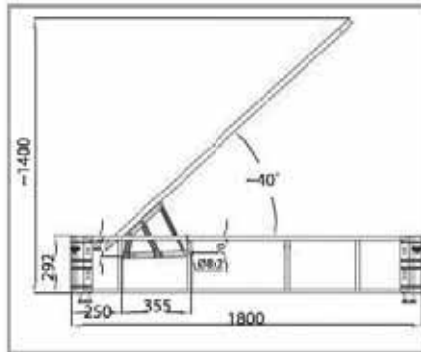
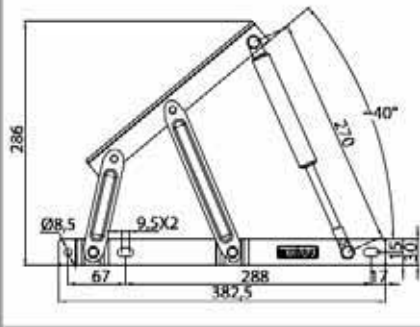

- Baza sistemli yataklarda kullanılır. Gazlı amortisör yardımı ile baza kapağının 40 derece açılmasını sağlar. 300 ve 1200 newton arasında gazlı amortisör kullanılır.
- Bed mechanism (small) is in use in base system beds. By the support of gas spring the base cover can lift up to 40 degrees. It can be used in the midst of 300 and 1200 nw gas springs.

M02010144 Ürün No/Prod. No: 406  
AMORTİSÖRLÜ BAZA MEKANİZMASI (Kilitli)  
BED MECHANISM (WITH LOCKER)

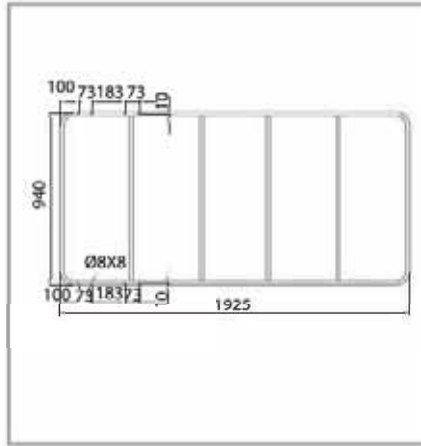
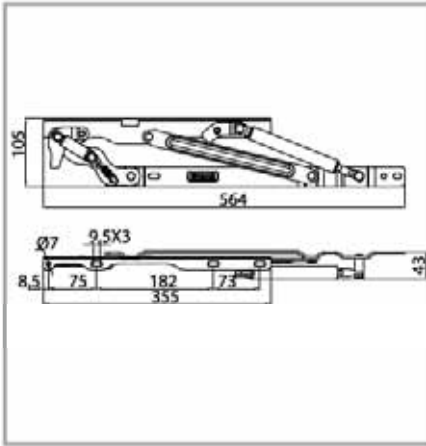
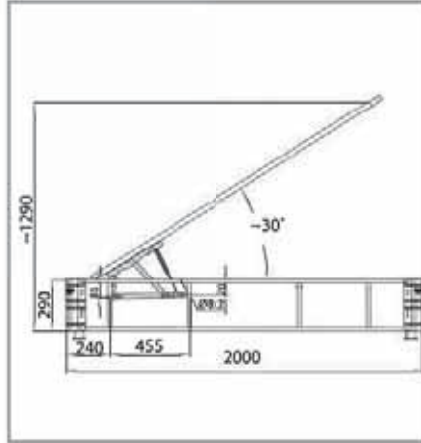
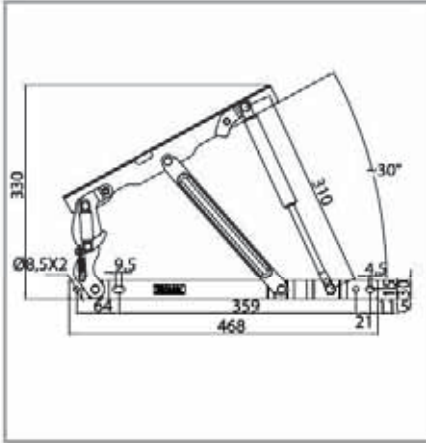

• Baza sistemli yataklarda kullanılır. Gazlı amortisör yardımı ile baza kapağının 30 derece açılmasını sağlar. 300 ve 1200 newton arasında gazlı amortisör kullanılır. Baza kapağı açıldığında kilit sistemi otomatik olarak devreye girer ve baza kapağı kapanmaz. Kapağı kapatmak için 10 cm kadar yukarı kaldırılır ve kilit devre dışı kalarak kapak kapatılır.

• Bed mechanism with locking system is in use in base system beds. By the support of gas spring the base cover can lift up to 40 degrees. It can be used in the midst of 300 and 1200 nw gas springs. When opening up the base cover the lockin system steps in and the base cover is not going to get closed. For to unlock the locking system, base cover has to be lift up about 10 cm more and the cover get closed.



M02010145 Ürün No/Prod. No: 407  
AMORTİSÖRLÜ BAZA MEKANİZMASI LUX  
BED MECHANISM LUX

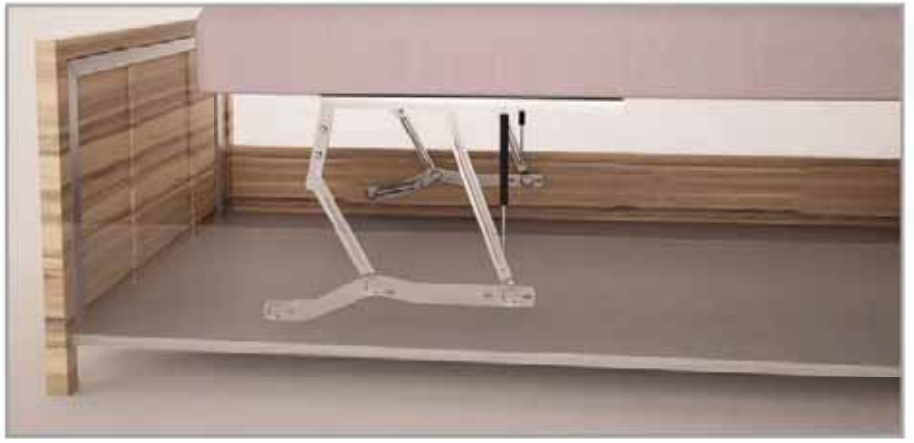
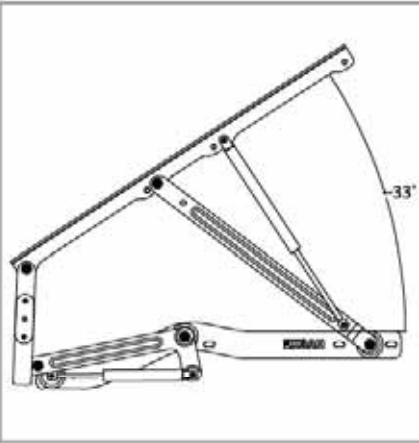
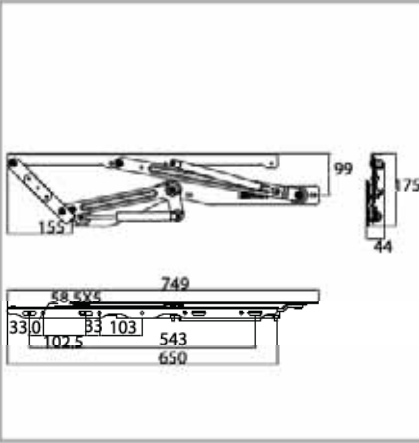
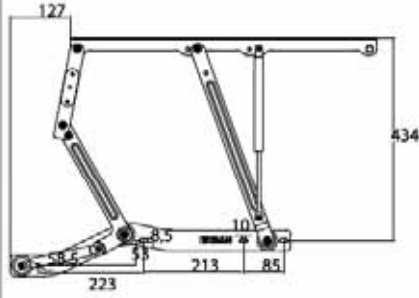

• Baza sistemli yataklarda kullanılan gazlı amortisör yardımıyla bazanın 33 derece kadar açılarak sandık olarak kullanılmasını sağlayan bunun yanında sandık pozisyonunda iken öne doğru çekilerek yatak kısmının düz bir platform gibi kalmasını sağlayıp nevresim vb. gibi değişimleri kolaylaştıran fonksiyonel mekanizmadır. 1tk mekanizmada 4 adet gazlı amortisör kullanılır.

• Bed mechanism lux is a functional mechanism that provides to become a case with a 33 degrees opening up position by the support of gas spring besides when in case position by pulling front it can stay as a flat platform for to change the bed clothes easier.

M02010302 Ürün No/Prod. No: 47  
EKSTRA KÜÇÜK AMORTİSÖRLÜ MEKANİZMA  
EXTRA SMALL GAS SPRING MECHANISM

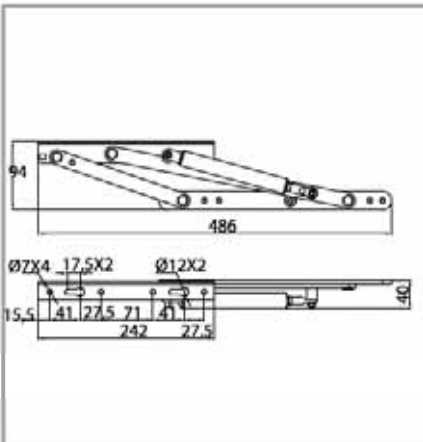
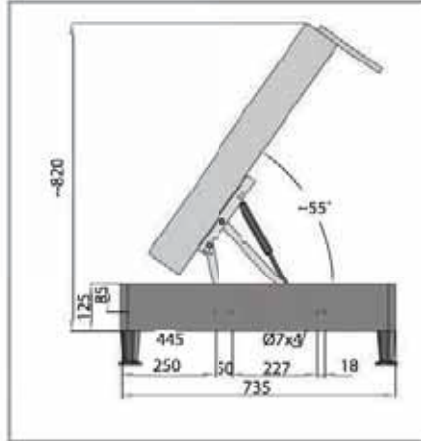
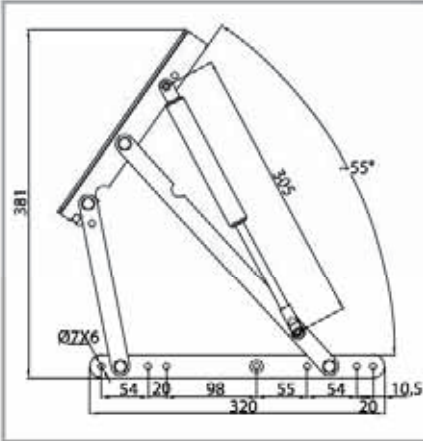

• Baza sistemli yataklarda kullanılır. Gazlı amortisör yardımı ile baza kapağının 40 derece açılmasını sağlar. 300 ve 1200 newton arasında gazlı amortisör kullanılır. Bazanın sandık amaçlı kullanılmasına sağlar.

• Ext. Small gas spring mechanism is in use in base system beds. By the support of gas spring the base cover can lift up to 40 degrees. It can be used in the midst of 300 and 1200 nw gas springs. It provides to use the base as a case.

M02010312 Ürün No/Prod. No: 49  
EKSTRA BÜYÜK AMORTİSÖRLÜ MEKANİZMA  
EXTRA BIG GAS SPRING MECHANISM

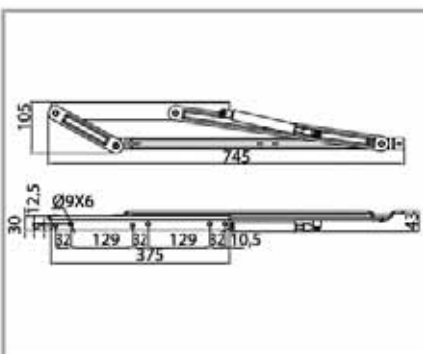
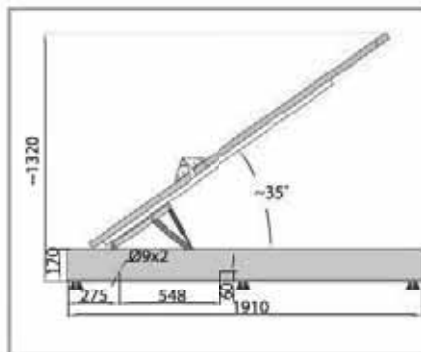
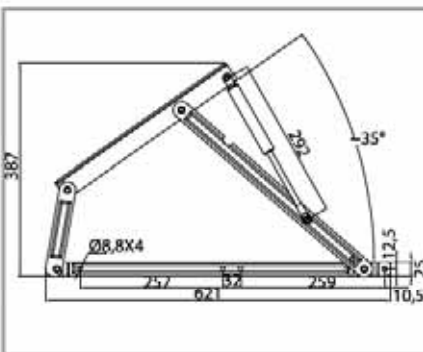

• Geniş hacimli baza sistemlerinde kullanılır. Gazlı amortisör yardımıyla baza kapağının 35 derece açılmasını sağlar. 300-1350 newton arasında gazlı amortisör kullanılır. Bazanın sandık amaçlı kullanılmasına sağlar.

• Extra big gas spring mechanism is used in basebed systems of wide volume. It provides the hatch to be opened 35 degrees by the assistance of a gas spring. Gas springs between 300 nw and 1350 nw are used. It allows the baseframe to be used as a case.

M02010315 Ürün No/Prod. No: 50

EKSTRA BÜYÜK UZUN AYAKLI  
AMORTİSÖRLÜ MEKANİZMA  
EXTRA BIG LONG LEGGED GAS  
SPRING MECHANISM

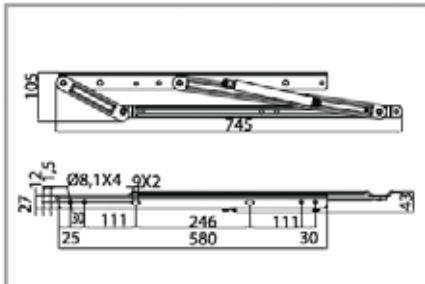
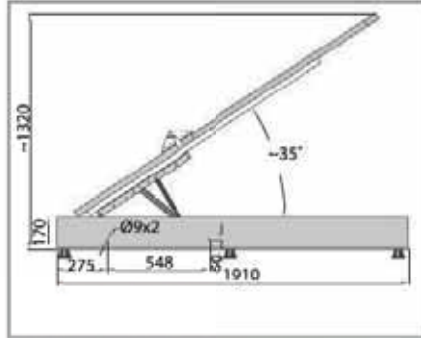
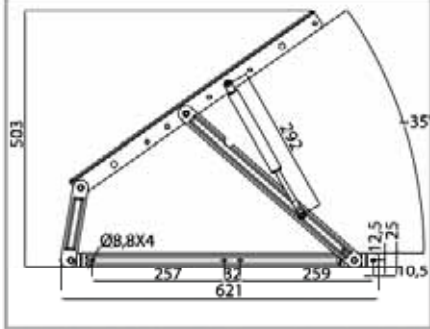

• Geniş hacimli baza sistemlerinde kullanılır. Gazlı amortisör yardımıyla baza kapağının 35 derece açılmasını sağlar. 300-1350 newton arasında gazlı amortisör kullanılır. Sandık pozisyonunda iken ağır yatakları (80kg) taşıyabilmesi için tasarlanmıştır. Bazanın sandık amaçlı kullanılmasını sağlar.

• Ext. Big long legged gas spring mechanism is in use in base system beds. By the support of gas spring the base cover can lift up to 35 degrees. It is designed for to carry the weights up to 80 kilos while in case position. It can be used in the midst of 300 and 1350 nw gas springs. It provides to use the base as a case.

M02010316 Ürün No/Prod. No: 51

EKSTRA BÜYÜK BAZA MEKANİZMASI (KIZAKLI)  
EXTRA BIG BED MECHANISM  
(WITH SLIDING SYSTEM)

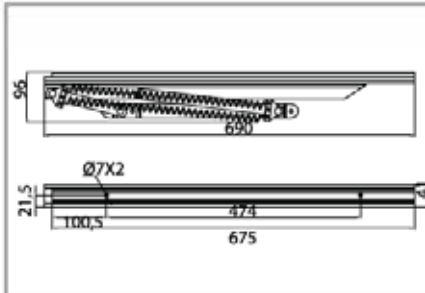
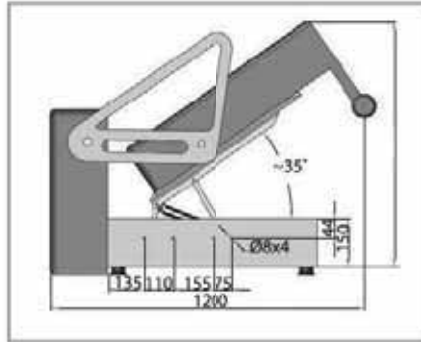
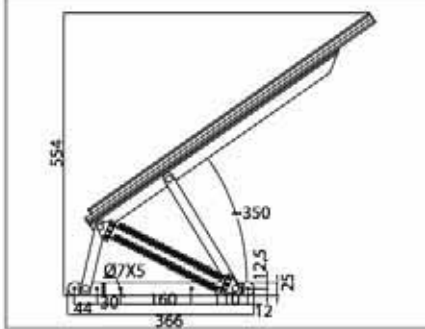

• Geniş hacimli kanepelerde oturma fontunu yay yardımı ile yukarı kaldırarak 35 derece açılıp iskeletin sandık olarak kullanılmasını sağlar. Kızakları yardımı ile oturma fontunun öne doğru çekilerek kanepenin geniş bir yatak olarak kullanılmasına olanak verir.

• Ext. Big bed mechanism (with sliding system) provides the sitting part of the couches especially with high volume to open up 35 degrees enabling the frame to be used as a case. Also with the assistance of its slider, this mechanism allows bringing the sitting part forward to transform the couch into a larger bed.



**M02010300 Ürün No/Prod. No: 46**  
**EKSTRA KÜÇÜK SANDIK MEKANİZMASI**  
**EXTRA SMALL CASE MECHANISM**

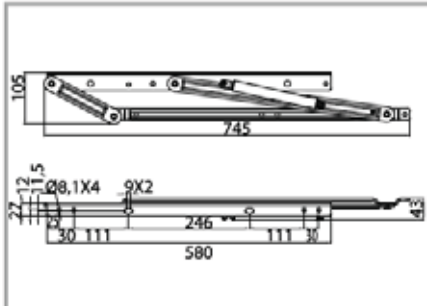
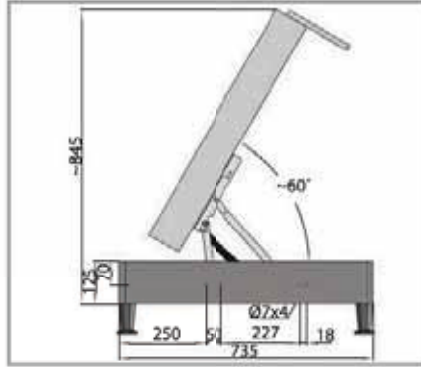
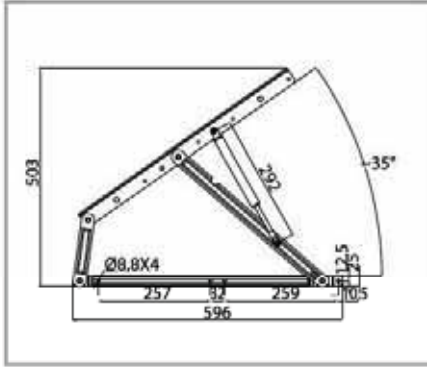

- Kanepi köşe uzantılarının ve puflarının yay yardımı ile 60 derece açılmasını sağlar. İskeletin iç kısmının sandık amaçlı kullanılmasını sağlar.
- Ext. Small case mechanism provides corner extensions and pouffes to open 60 degrees with the assistance of a spring. It allows the frame inside to be used as a case.

**M02010310 Ürün No/Prod. No: 48**  
**EKSTRA BÜYÜK SANDIK MEKANİZMASI**  
**EXTRA BIG CASE MECHANISM**

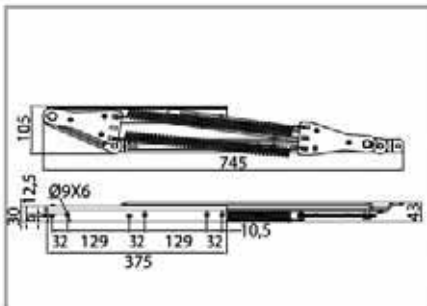
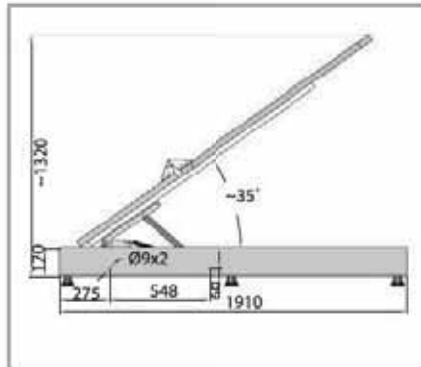
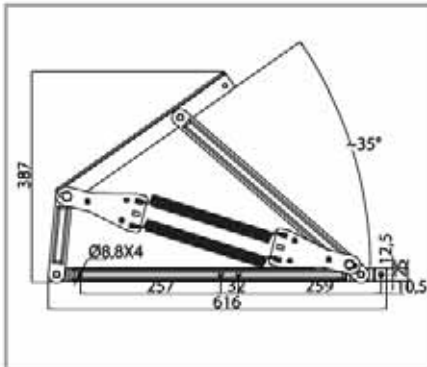

- Geniş hacimli baza sistemlerinde kullanılır. Yay yardımıyla baza kapağının 35 derece açılmasını sağlar. Bazanın sandık amaçlı kullanılmasına sağlar.
- Ext. Big case mechanism is used in basebed systems of high volume. It allows the hatch of the basebed to open 35 degrees and provides the bed to be used as a case.



**M02010130 Ürün No/Prod. No: 52**  
**KÜÇÜK SANDIK MEKANİZMASI**  
**SMALL CASE MECHANISM**

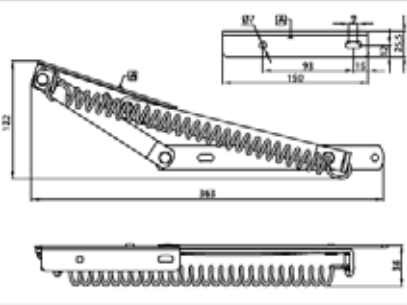
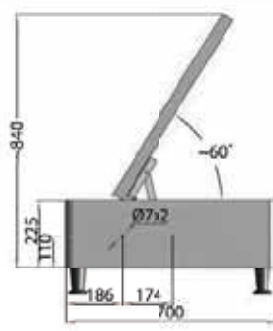
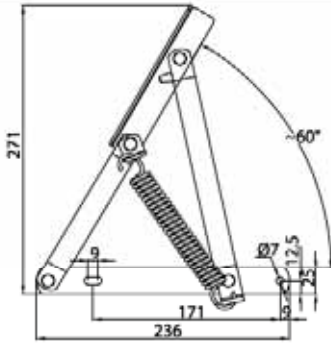

- Kanepe köşe uzantılarının ve puflarının yay yardımı ile 60 derece açılmasını sağlar. İskeletin iç kısmının sandık amaçlı kullanılmasını sağlar.
- Small case mechanism is used in couch's corner extensions and pouffes providing a 60 degrees opening to allow the inner side to be used as a case.

**M02010131 Ürün No/Prod. No: 53**  
**AVRUPA KÜÇÜK SANDIK MEKANİZMASI**  
**EUROPE SMALL CASE MECHANISM**

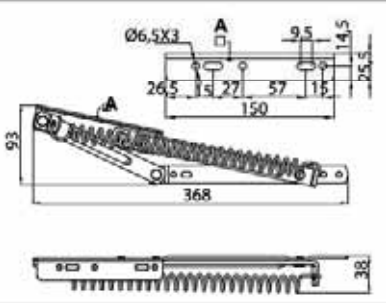
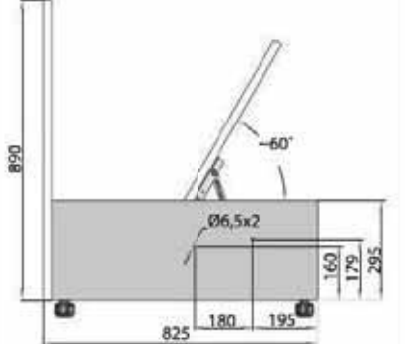
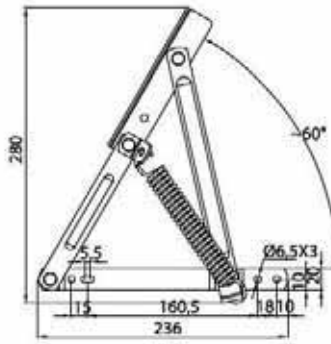

- Kanepe köşe uzantılarının ve puflarının yay yardımı ile 60 derece açılmasını sağlar. İskeletin iç kısmının sandık amaçlı kullanılmasını sağlar.
- Europe small case mechanism is used in couch's corner extensions and pouffes providing a 60 degrees opening to allow the inner side to be used as a case.

M02010132 Ürün No/Prod. No: 408  
MİNİ SANDIK MEKANİZMASI  
MINI CASE MECHANISM

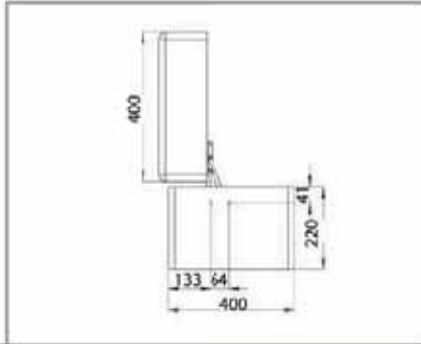
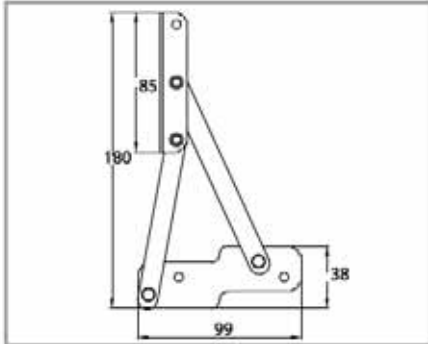
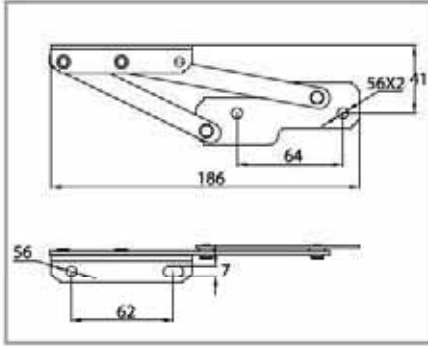

• Özellikle puf v.b. gibi yerde kullanılan mekanizmadır, açılan kapak mekanizmanın tasarımı sayesinde 90 derecelik bir açı ile dik durabilmektedir.

• Mini case mechanism is especially used in pouffes and the furniture alike. The design of the cover part of the mechanism provides a 90 degrees straight standing.

M02010140 Ürün No/Prod. No: 54  
BÜYÜK SANDIK MEKANİZMASI  
BIG CASE MECHANISM

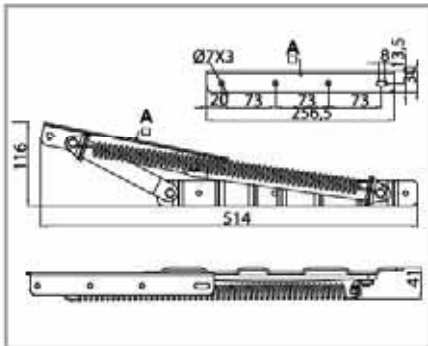
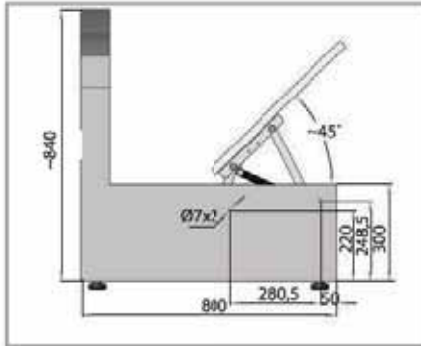
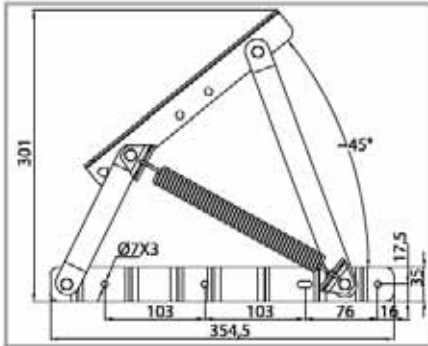

• Geniş hacimli kanepelerin ve köşe takımlarının oturma fontunun yay yardımıyla 45 derece açılmasını sağlar. İskeletin iç kısmının sandık amaçlı kullanılmasını sağlar.

• Big case mechanism is used in sofas and corner sets of large volume by providing to open the sitting part 45 degrees by a spring so that the inner framing can be used as a case.

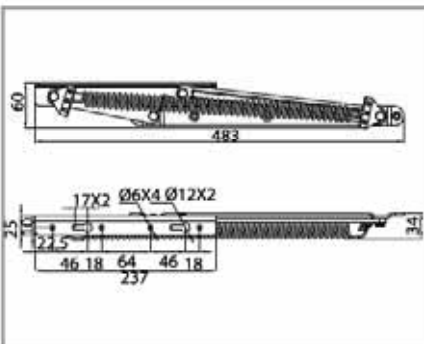
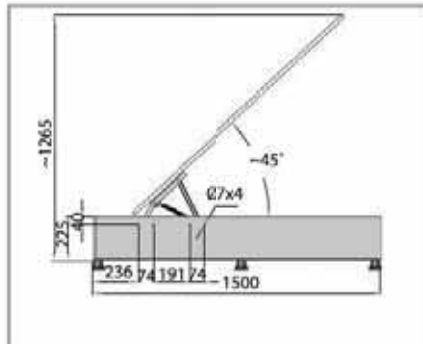
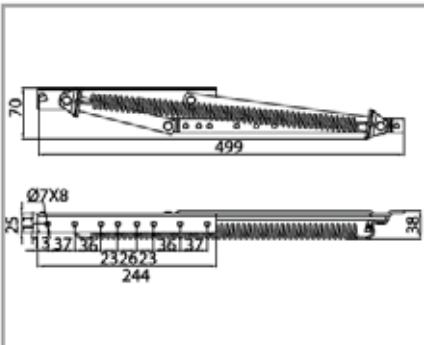
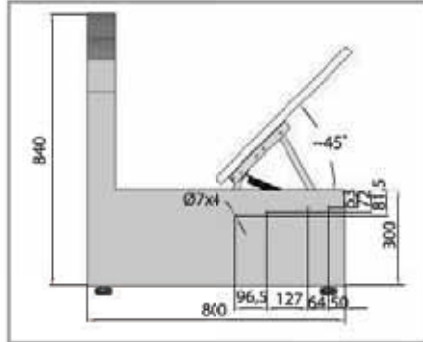



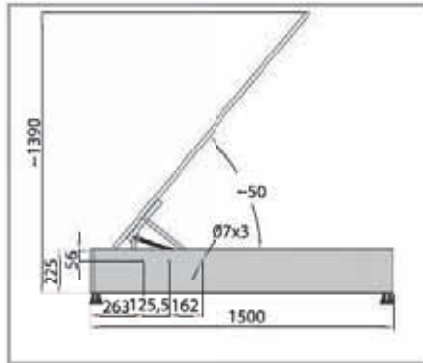

- 
- A light-colored, modern sofa with a reclining footrest extended. The sofa has a clean, minimalist design with dark wood or metal legs. The footrest is a thick, padded cushion that has been pulled out from under the seat.

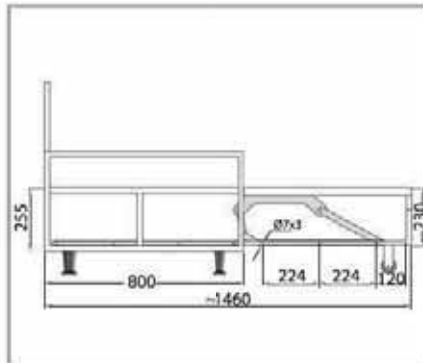

- 47



**AVANTI SÜRYAT MEKANİZMASI PROFİLLİ**  
**AVANTI SÜRYAT MECHANISM WITH PROFILE**



- Avanti suryat mechanism with profile provides, profile and wooden skeleton couches being a bed with a half circular angle move by pulling and then lifting the case under the sitting part. Besides cause of profile it provides margin advantage and makes the base case workmanship much more easier.

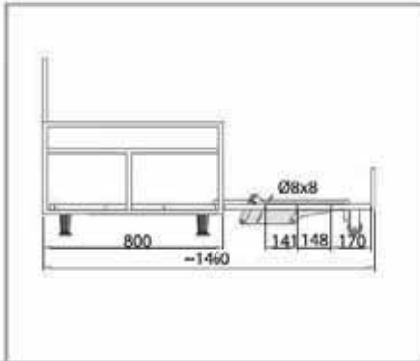

M02010120 Ürün No/Prod. No: 58  
KÖŞE MEKANİZMASI  
CORNER MECHANISM

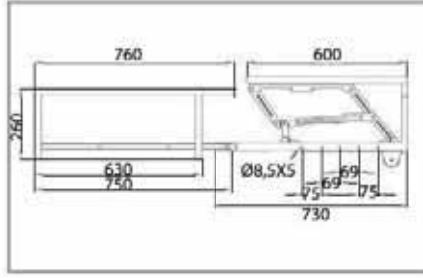
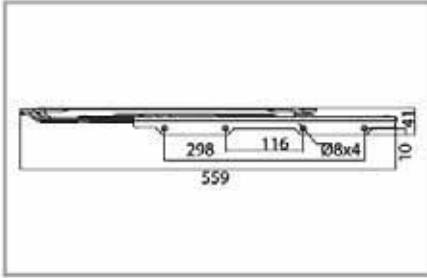
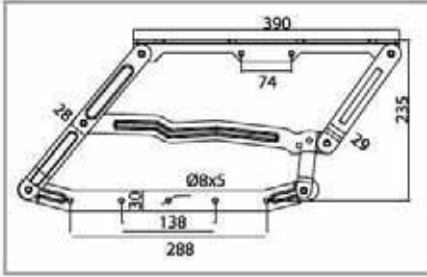

M02010122 Ürün No/Prod. No: 63  
KÖŞE MEKANİZMASI (KÜÇÜK)  
CORNER MECHANISM (SMALL)

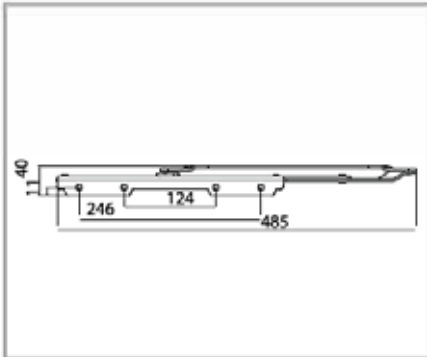
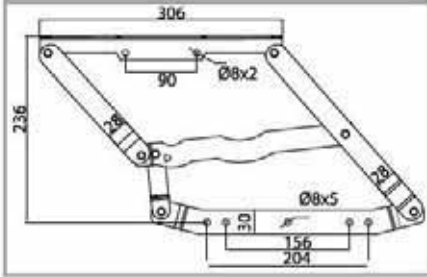

- Profil ve ahşap iskeletli kanepelerde kanepenin oturma fonu altındaki kasanın çekilip kaldırılması suretiyle yarı dairesel bir hareket açısıyla yatak olabilme özelliği sağlayan mekanizmadır.
- Corner mechanism is used in the sofas with wooden frame or metal profile frame to transform the sofa into a bed by drawing semi-circular angle movement.

**M02010123 Ürün No/Prod. No: 61**  
**KÖŞE RAPİSODİ MEKANİZMASI**  
**CORNER RAPİSODİ MECHANISM**

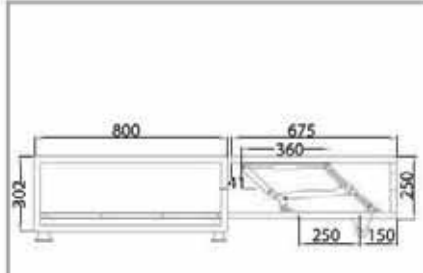
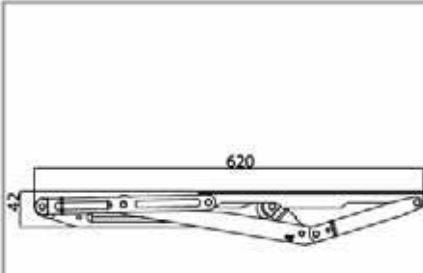
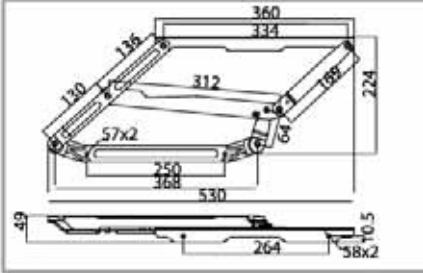

• Profil ve ahşap iskeletli kanepelerde kanepenin oturma fontu altındaki kasanın çekilip kaldırılması suretiyle yarı dairesel bir hareket açısıyla yatak olabilmeye özelliği sağlayan mekanizmadır.

• Corner rapsodi mechanism is used in the sofas with wooden frame or metal profile frame to transform the sofa into a bed by drawing semi-circular angle movement.

**M02010350 Ürün No/Prod. No: 64**  
**SOFT KÖŞE MEKANİZMASI**  
**SOFT CORNER MECHANISM**

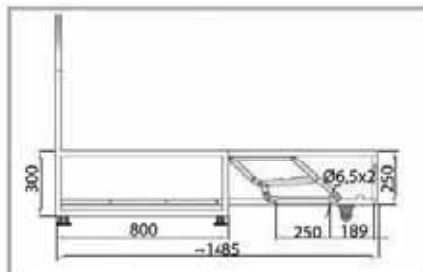
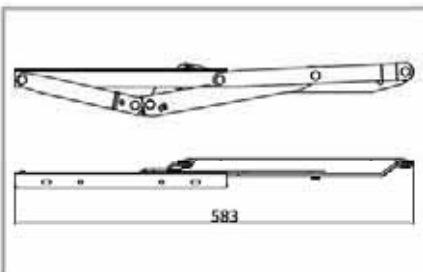
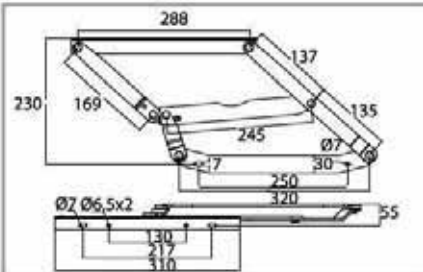

• Profil ve ahşap iskeletli kanepelerde kanepenin oturma fontu altındaki kasanın çekilip kaldırılması suretiyle yarı dairesel bir hareket açısıyla yatak olabilmeye özelliği sağlayan mekanizmadır.

• Soft corner mechanism is used in the sofas with wooden frame or metal profile frame to transform the sofa into a bed by drawing semi-circular angle movement.

**M02010270 Ürün No/Prod. No: 59**  
**RAY KIZAĞI MEKANİZMASI**  
**SLIDING MECHANISM**

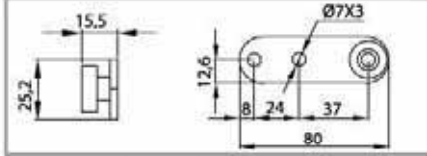
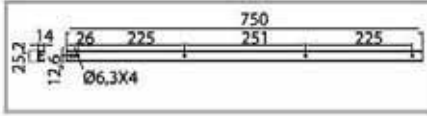

- Profil ve ahşap iskeletli kanepelerde kanepenin oturma fonu altındaki kasanın çekmece setinde çekilerek kolayca çıkmasını sağlar.
- Sliding mechanism is used in the sofas with wooden frame or metal profile frame to pull the case under sitting part easily as a drawer.

**M02010280 Ürün No/Prod. No: 60**  
**PLASTİK MAKARA TAKIMI**  
**PLASTIC BLOCK-TACKLE SET**

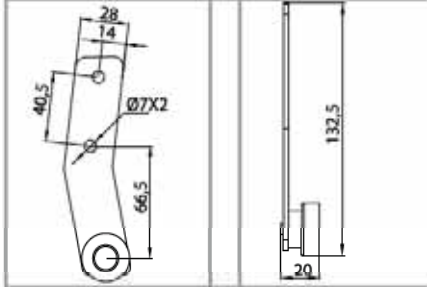

- Çelik sac üzerine monte edilmiş plastik makara ahşap ve metal kanallarda yuvarlanarak açılıp yatak olan sistemlerde hareket kolaylığı sağlar.
- Plastic block-tackle set is a pulley mounted on steel sheet which is a facilitator at bed systems by sliding on wooden or metal canal.

**M02010400 Ürün No/Prod. No: 62**  
**KAPAK MEKANİZMASI**  
**COVER MECHANISM**

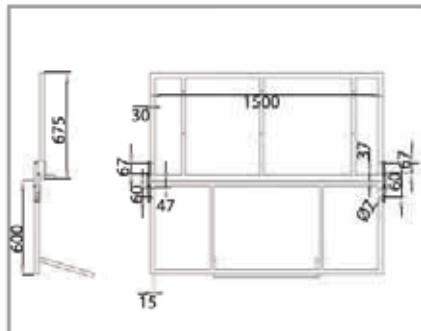
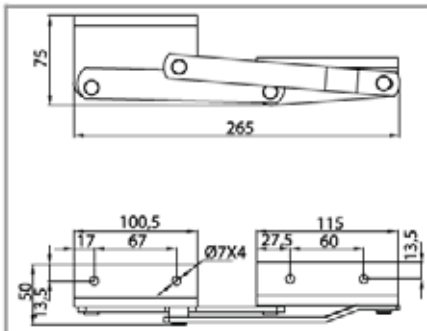
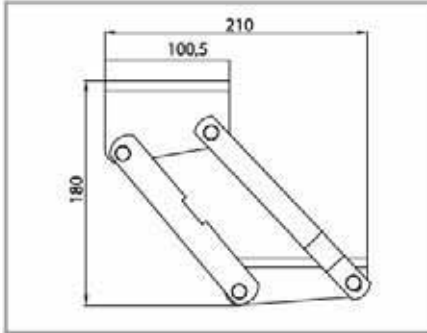

- Özellikle iki kişilik kanepelerde oturma fonu altındaki kasanın çekilip kaldırılması suretiyle daha büyük yatak olmasını sağlar. Köşe mekanizmaları ile birlikte kullanılır.
- Cover mechanism is especially used in double sofas to lift the case under the sitting part allowing the sofa to become a bigger bed. It is used with corner mechanisms.



M02010171 Ürün No/Prod. No: 71  
YENİ İKİZ YATAK MEKANİZMASI  
NEW TWIN BED MECHANISM

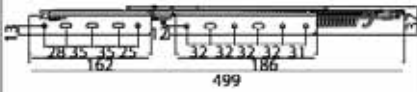
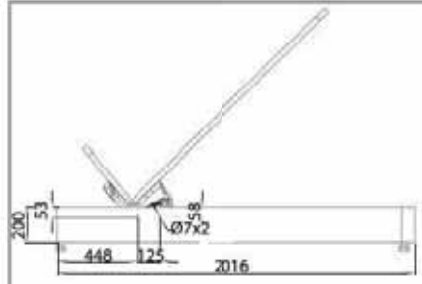
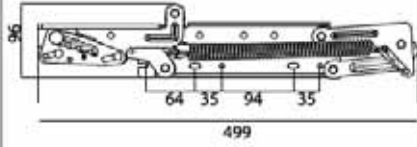

- Latalı ve bazalı yatakları baş ucunu dört ayrı kademede ayarlanmasını sağlar. Ayak ucunun 45 derece açılmasını ve iskeletin iç kısmının sandık amaçlı kullanılmasını sağlar.

- New twin bed mechanism is used to adjust the head side in four different steps. It is also used to open the foot side at 45 degrees allowing to use the inside of the frame as a case.



M02010340 Ürün No/Prod. No: 72  
LATA MEKANİZMASI  
LATH MECHANISM

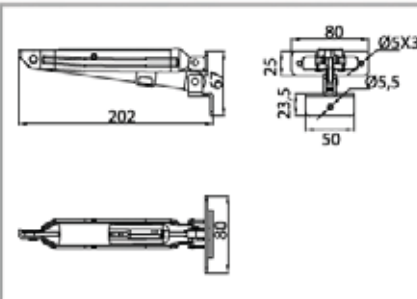
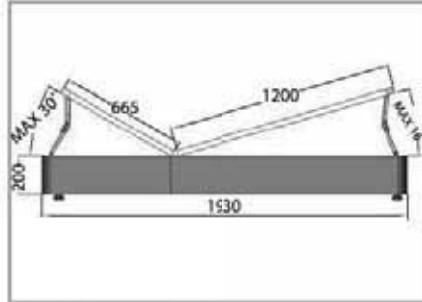
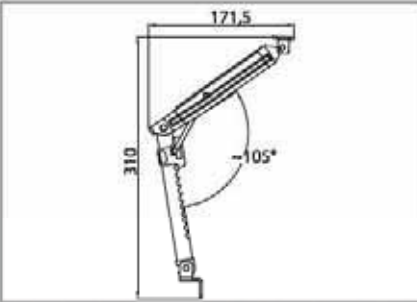

- Latalı ve bazalı yataklarda baş ve ayak ucunun 10 ayrı kademede açılmasını sağlar.

- Lata mechanism is used in the beds with lath or base to open the head and foot sides in 10 different steps.

**M02010415 Ürün No/Prod. No: 73**  
**SIRT MEKANİZMA MENTEŞESİ**  
**BACK MECHANISM HINGE**

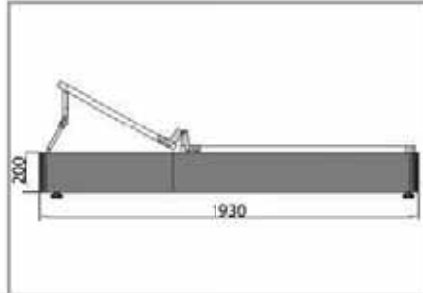
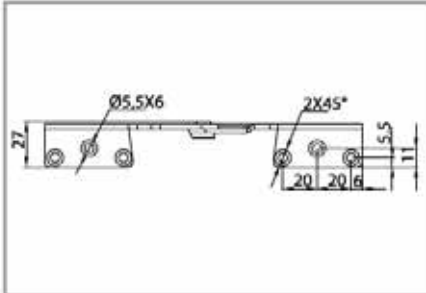
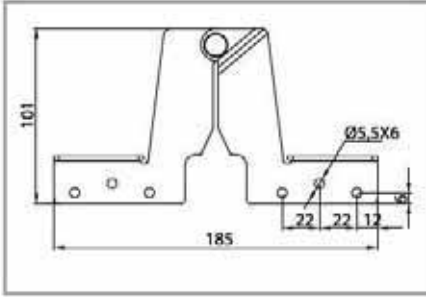

- Ahşap iskeletli baza kapaklarını iki ayrı parça halinde yapıldığında baş kısmına montajlanıp yardımcı aparatlarla dinlenme pozisyonu sağlayan menteşe vazifesi görür.
- Back mechanism hinge functions as a hinge, supporting a resting position by implementing to the head part, used with auxiliary apparatus when the hatch is produced in two pieces.

**M02010416 Ürün No/Prod. No: 74**  
**SIRT MEKANİZMA MENTEŞESİ (KALIN)**  
**BACK MECHANISM HINGE (THICK)**

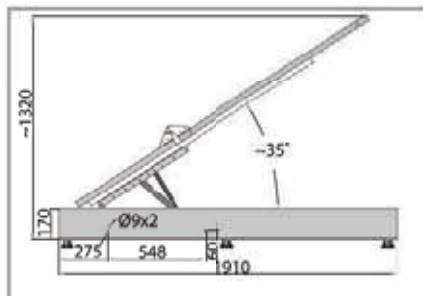
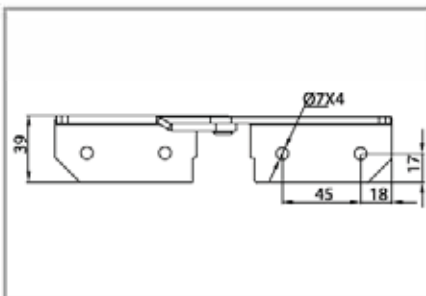
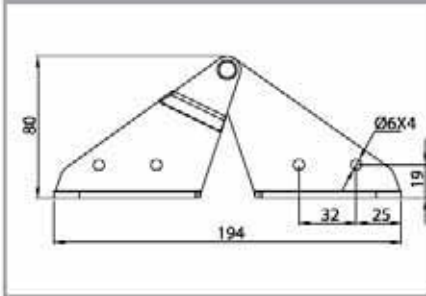

- Ahşap iskeletli baza kapaklarını iki ayrı parça halinde yapıldığında baş kısmına montajlanıp yardımcı aparatlarla dinlenme pozisyonu sağlayan menteşe vazifesi görür.
- Back mechanism hinge functions as a hinge, supporting a resting position by implementing to the head part, used with auxiliary apparatus when the hatch is produced in two pieces.

M02010390 Ürün No/Prod. No: 67  
SOFA MEKANİZMASI  
SOFA MECHANISM

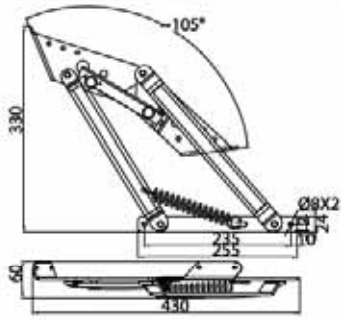

• Ahşap iskeletli kanepelerde kullanılan kanepenin oturma pozisyonundan sandık ve yatak haline dönüşümünü sağlayan mekanizmadır. Tekli, ikili ve üçlü kanepelerde kullanılır.

• Sofa mechanism is used in the sofas with wooden framing to adjust the sofa from sitting position to case or bed position. Used in single, double or triple types of sofas.

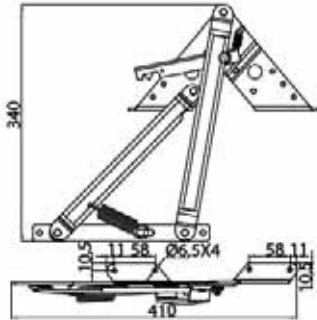

M02010290 Ürün No/Prod. No: 68  
BALKAN MEKANİZMASI (BÜYÜK)  
BALKAN MECHANISM (BIG)

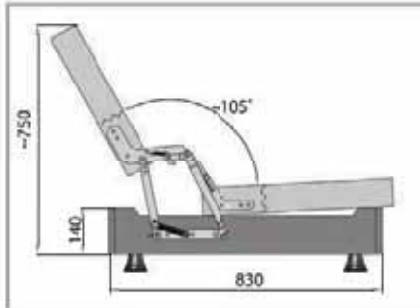
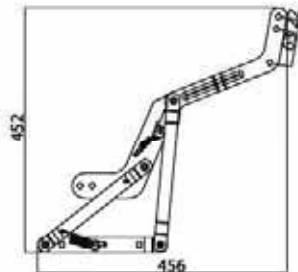
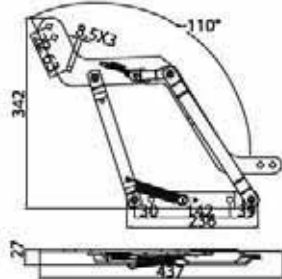

• Ahşap iskeletli kanepelerde kullanılan kanepenin oturma pozisyonundan sandık ve yatak haline dönüşümünü sağlayan mekanizmadır. Tekli, ikili ve üçlü kanepelerde kullanılır.

• Balkan mechanism is used in the sofas with wooden framing to adjust the sofa from sitting position to case or bed position. Used in single, double or triple types of sofas.

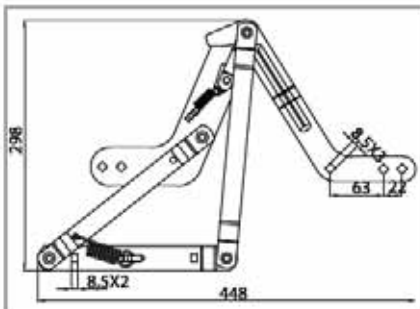



M02010291 Ürün No/Prod. No: 69  
BALKAN MEKANİZMASI (KÜÇÜK)  
BALKAN MECHANISM (SMALL)

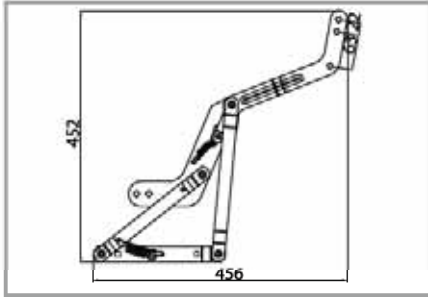
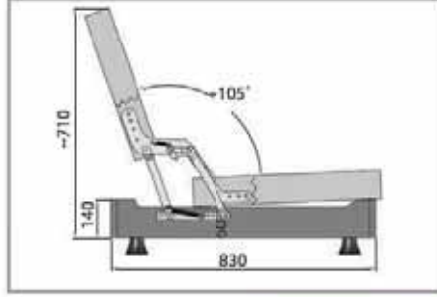
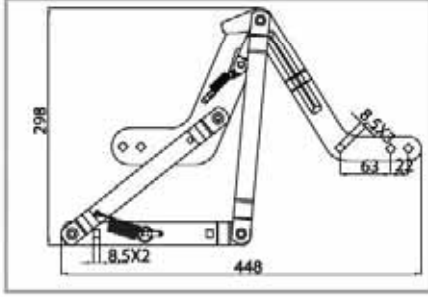
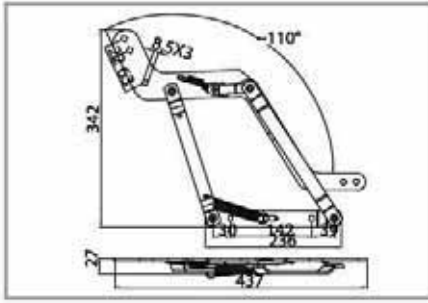

M02010292 Ürün No/Prod. No: 70  
BALKAN MEKANİZMASI (KÜÇÜK KISA KOLLU)  
BALKAN MECHANISM (SMALL SHORT ARMED)

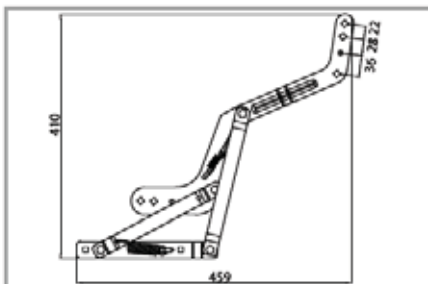
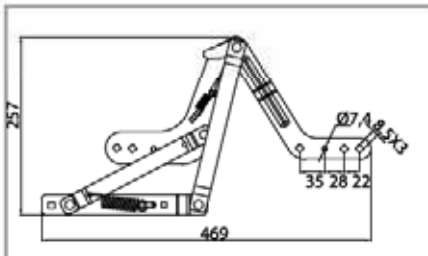
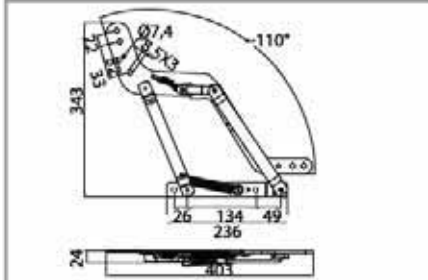

- Ahşap iskeletli kanepelerde kullanılan kanepenin oturma pozisyonundan sandık ve yatak haline dönüşümünü sağlayan mekanizmadır. Tekli, ikili ve uçlu kanepelerinde kullanılır.
- Balkan mechanism is used in the sofas with wooden framing to adjust the sofa from sitting position to case or bed position. Used in single, double or triple types of sofas.



M02010250 Ürün No/Prod. No: 76  
KOL KAVRAMA KIZAĞI (12 cm)  
SLIDING HINGE (12 cm)

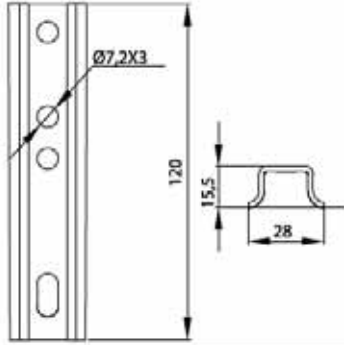
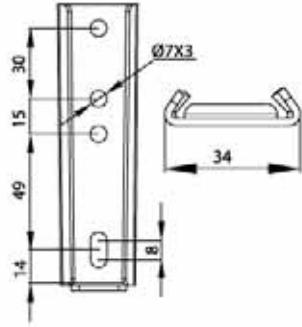

M02010251 Ürün No/Prod. No: 77  
KOL KAVRAMA KIZAĞI (15 cm)  
SLIDING HINGE (15 cm)

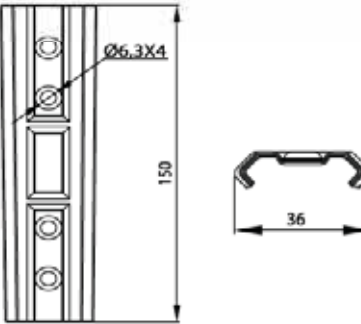
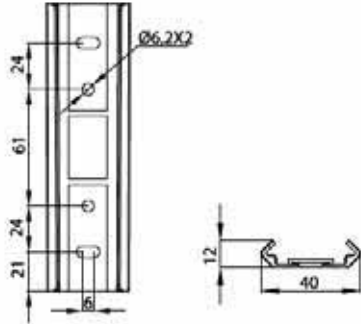

- Yatak başlıklarının ve kanepeler kollarının pratik olarak kızak geçme yöntemiyle sökölüp takılmasını sağlar.
- Sliding hinge is used to attach and detach the headpiece or armrest practically by the way of sliding.

M02010253 Ürün No/Prod. No: 78  
KOL KAVRAMA KIZAĞI (17 cm)  
SLIDING HINGE (17 cm)

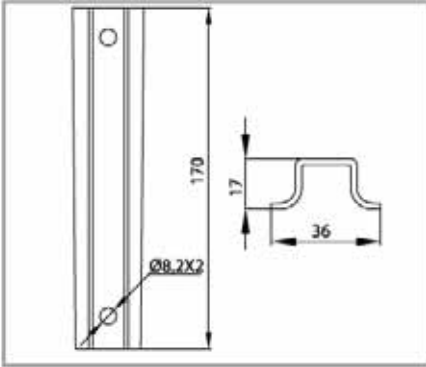
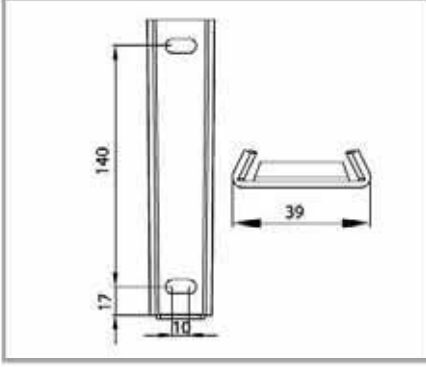

M02010252 Ürün No/Prod. No: 79  
KOL KAVRAMA KIZAĞI (19 cm)  
SLIDING HINGE (19 cm)

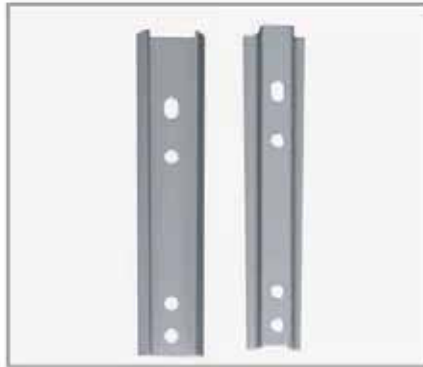
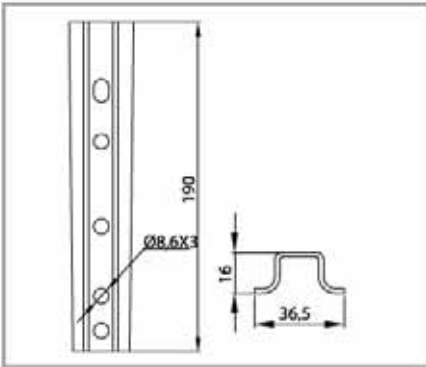
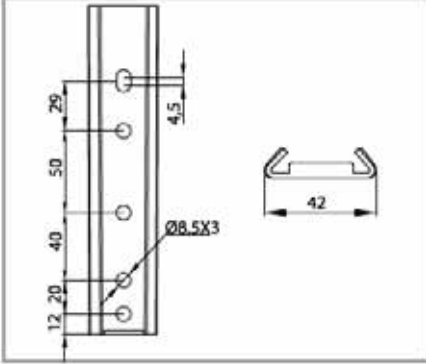

- Yatak başlıklarının ve kanepeler kollarının pratik olarak kızak geme yöntemiyle sökülüp takılmasını sağlar.
- Sliding hinge is used to attach and detach the headpiece or armrest practically by the way of sliding.

M02010230 Ürün No/Prod. No: 80

BAĞLANTI PULU  
CONNECTOR SCALE

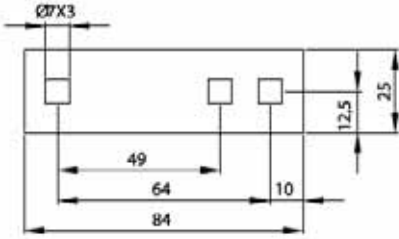

• Japon mekanizmalarının montajında somun sıkılınca profili ezmesini engelleyerek profile hasar oluşmasını önleyen ve profilin uzun ömürlü olmasını sağlayan puldur.

• connection shim is used to protect the steel sheet of japon mechanisms from being crushed when the nut is tightened, provides a long life to the profile.

M02010240 Ürün No/Prod. No: 81

KELEPÇE SACI  
CONNECTION SHEET

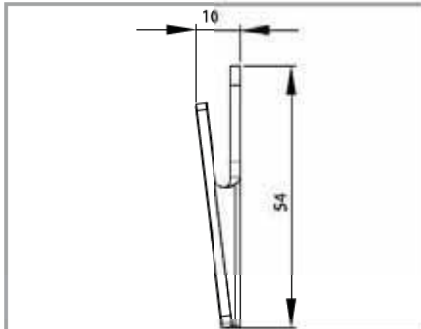
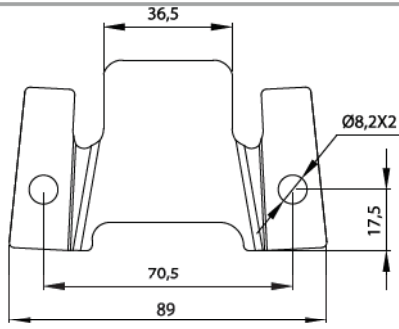

• Köşe koltuk takımlarında köşelerin birbirine bağlanmasını sağlayan parçadır.

• Connection sheet is used in corner sets to assemble the corner parts to each other.

M02010240-1 Ürün No/Prod. No:416

KELEPÇE SACI BÜYÜK  
CONNECTION SHEET BIG

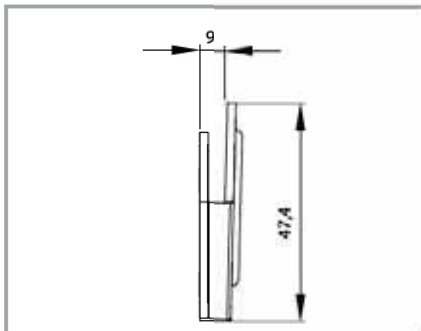
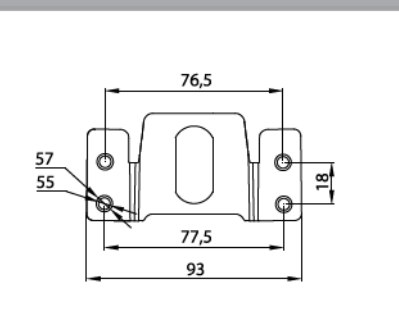

• Köşe koltuk takımlarında köşelerin birbirine birleştirilmesini sağlayan bağlantı kelepçesidir. Özellikle ahşap ürünlerin bağlanması için bağlantı delikleri havşalı ve ağaç vidasına uygun olarak yapılmıştır.

• it is the connection clamp providing the connection of Corners in corner Sofa sets .The Mechanism especially made for to connect countersunk bolts and wooden nuts to wooden products.

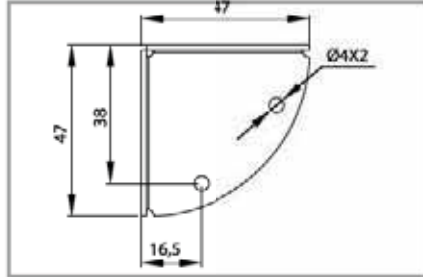
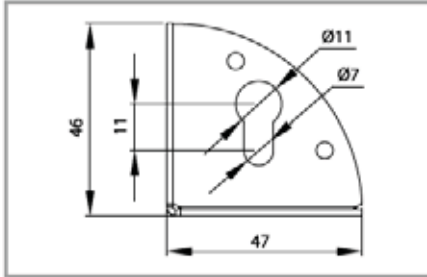
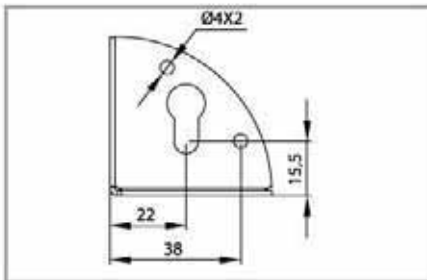

M02010242 Ürün No/Prod. No: 83  
BAZA KULBU MENTEŞESİ  
BASE HANDLE HINGE

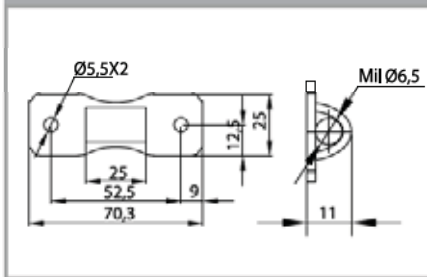

- Bazaların kapaklarına montajlanarak baza kulbunun sonradan takılarak menteşe gibi dönerék çalışmasını sağlar.
- Base handle sheet provides the base handle rotate like a hinge when montaged to the base hatch.



M02010330 Ürün No/Prod. No: 85

**MENTEŞE BÜYÜK**  
HINGE BIG

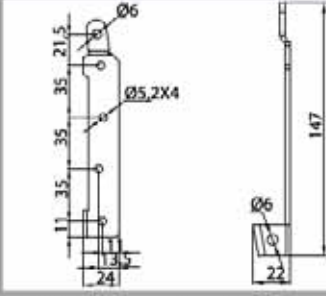

• Mobilya sanayinde mdf vb.gibi ürünlerde iki ayrı parçanın köşe noktalarından birleşmesinde karşılıklı kullanılarak kolayca montaj olmasını sağlayan bağlantı parçasıdır.

• Hinge (big) is the item which provides simple adjunction to the corner points of materials such as mdf and alike which are used in the furniture industry.

M02010331 Ürün No/Prod. No: 86

**MENTEŞE KÜÇÜK**  
HINGE SMALL

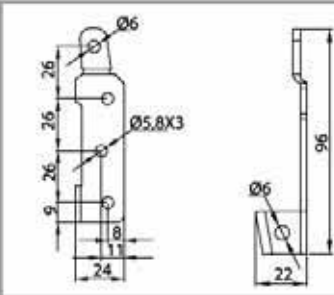

• Mobilya sanayinde mdf vb.gibi ürünlerde iki ayrı parçanın köşe noktalarından birleşmesinde karşılıklı kullanılarak kolayca montaj olmasını sağlayan bağlantı parçasıdır.

• Hinge (small) is the item which provides simple adjunction to the corner points of materials such as mdf and alike which are used in the furniture industry.

M02010335 Ürün No/Prod. No: 87

**MENTEŞE KATLANIR**  
COLLAPSIBLE HINGE

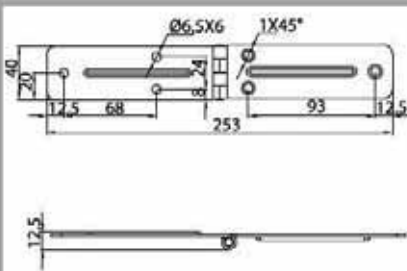

• Mobilya sanayinde menteşe görevi görür.

• Collapsible hinge functions as a hinge in the furniture industry.

• Mobilya sanayinde menteşe görevi görür.

• Collapsible hinge (thick) functions as a hinge in the furniture industry.

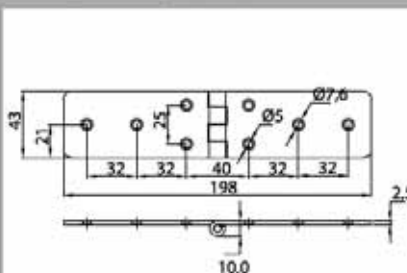

M02010336 Ürün No/Prod. No: 411

**MENTEŞE KATLANIR KALIN**  
COLLAPSIBLE HINGE (THICK)

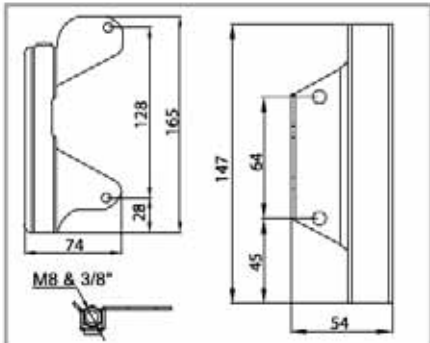
[illegible]

- It is the mechanism providing easy disassembly and assembly of sofa and chair arms.



- 

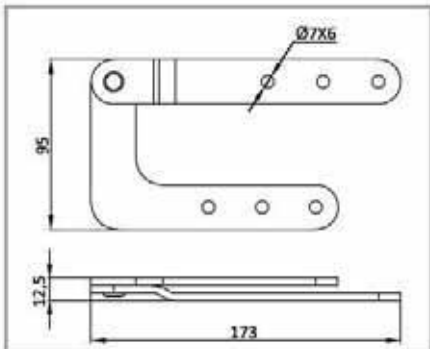









[www.marmaramalzeme.com](http://www.marmaramalzeme.com)

## MARMARA MALZEMECİLİK SAN. ve TİC. LTD. ŞTİ.

### Kartal Merkez/Main Office:

Soğanlık, Orta Mah. Yalnız Selvi Cad.  
No:17/1, 34880 Kartal, İstanbul, TURKEY  
GPS: 40.913276N, 29.209175E  
Tel: (+90 216) 451 20 59 - 451 75 85  
Faks/Fax: (+90 216) 377 87 26 - 377 23 52  
GSM: (+90 533) 639 61 35

### Bayrampaşa Şube/Branch Office:

Yenidoğan Mah. Numunebağ Cad. Çınar Sk.  
No:10/A, Bayrampaşa, İstanbul, TURKEY  
GPS: 41.034745N, 28.913593E  
Tel: (+90 212) 674 66 90 - 91  
Faks/Fax: (+90 212) 674 66 89  
GSM: (+90 533) 477 88 38

### Güneşli Şube/Branch Office:

Mahmutbey Yolu Güneşli Mah. 13 Sok. No:59  
Motosan Binası Bağcılar İstanbul TURKEY  
GPS: 41.039188N, 28.832378E  
Tel: (+90 212) 630 34 34  
Faks/Fax: (+90 212) 630 29 29  
GSM: (+90 530) 961 64 64

### Soğanlık Şube/Branch Office:

Soğanlık, Orta Mah. Yalnız Selvi Cad.  
No:17/2, 34880 Kartal, İstanbul, TURKEY  
GPS: 40.913276N, 29.209175E  
Tel: (+90 216) 451 93 26 - 451 93 56  
Faks/Fax: (+90 216) 451 76 37

### Eksan Üretim Tesisleri/Eksan Factory:

2. Org. San. Böl. 2 Nolu Yol, No:14, 54300  
Kargalıhanbaba, Hendek, Sakarya, TURKEY  
GPS: 40.7577821N, 30.6445464E

### Marfom Üretim Tesisleri/Marfom Factory:

2. Org. San. Böl. 2 Nolu Yol, No:12, 54300  
Kargalıhanbaba, Hendek, Sakarya, TURKEY  
GPS: 40.7577821N, 30.6445464E